

HYDRANTS



FIG. 5509QT QUARTERHORSE-1/4 TURN SS BOX-TYPE HYDRANT W/INTEGRAL VACUUM BREAKER AND CONCEALED HOSE CONNECTION

FUNCTION: Provides positive non-freeze protection where water is required at the outside of the building and features an integral vacuum breaker. The stainless steel recessed box conceals the nozzle and operating mechanism. The locking cover prevents unauthorized use.

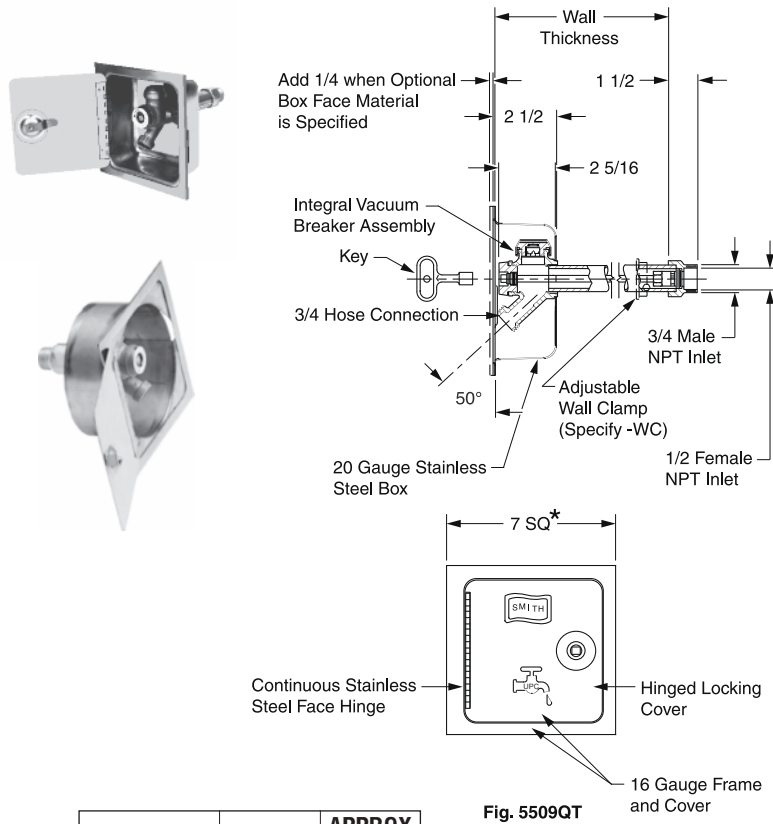

Fig. 5509QT

WALL THICKNESS	3/4" INLET	APPROX WEIGHT LBS
-SAP	1,332.00	8
06, 08"	1,544.00	9
10, 12, 14, 16"	1,687.00	10
18, 20, 22, 24"	1,829.00	11

REGULARLY FURNISHED: Bronze Nickel Plated Quarter Turn Non-Freeze Hydrant with Hose Connection, Integral Vacuum Breaker, "T" Handle Key, and Stainless Steel Box with Full 180° Cover Opening.

OPTIONS:

-CL	Cylinder Lock	187.00
-CP	Chrome Plated Face	303.00
-E	Elbow Inlet	45.00
-E1	1" NPT Elbow Inlet	260.00
-HC1	1" Hose Conn Adaptor	212.00
-IC1**	1" Male NPT Inlet Connection	212.00
-MF1	1" Straight Female Inlet	212.00
-NB	Nickel Bronze Face	277.00
-PB	Polished Bronze Face	61.00
-RB	Rough Bronze Face	61.00
-SE	Sweat Elbow Inlet	45.00
-SE1	1" NPT Sweat Elbow Inlet	260.00
-SS	Straight Sweat Inlet	N/C
-SS1	1" Straight Sweat Inlet	212.00
-SSR	6" Cored Hole Stainless Steel Box (Round)	275.00
-W	"Water" on Cover	N/C
-WC	Adjustable Wall Clamp	N/C

ADD

-CL	Cylinder Lock	187.00
-CP	Chrome Plated Face	303.00
-E	Elbow Inlet	45.00
-E1	1" NPT Elbow Inlet	260.00
-HC1	1" Hose Conn Adaptor	212.00
-IC1**	1" Male NPT Inlet Connection	212.00
-MF1	1" Straight Female Inlet	212.00
-NB	Nickel Bronze Face	277.00
-PB	Polished Bronze Face	61.00
-RB	Rough Bronze Face	61.00
-SE	Sweat Elbow Inlet	45.00
-SE1	1" NPT Sweat Elbow Inlet	260.00
-SS	Straight Sweat Inlet	N/C
-SS1	1" Straight Sweat Inlet	212.00
-SSR	6" Cored Hole Stainless Steel Box (Round)	275.00
-W	"Water" on Cover	N/C
-WC	Adjustable Wall Clamp	N/C

LIST

5509QTBASE	SS Box w/Hinged Locking Cover	680.00
5509QTBANB	SS Box w/Hinged Locking Cover w/NB Face	955.00
5509QTBAPB	SS Box w/Hinged Locking Cover w/PB Face	743.00
5509QTBARB	SS Box w/Hinged Locking Cover w/RB Face	743.00
5509QTBACK	SS Box w/Hinged Locking Cover w/CP Face	985.00

For Hydrant Parts Repair Kit, refer to Net Parts Price Guide.

NOTES:

- *Recommended wall opening 6" x 6". Hydrant shall be in the vertical position only, the connection must be on the bottom.
- When ordering, specify wall thickness in 2" increments as follows: 06, 08, 10, 12, 14, 16, 18, 20, 22 or 24. When wall clamp -WC is desired, increase wall thickness dimension by 2".
- All Jay R. Smith hydrants are manufactured with "NO-LEAD" brazing rings, and USDA approved lubricants.
- When an Optional Box Face Material is Specified a Concealed Hinge will be Provided, also add 1/4" to Flange Thickness.
- FOR IRRIGATION PURPOSES ONLY.**

** Add 3/4" to overall length when specified.

Seepage of a small amount of water may occur from the vacuum breaker upon the initial opening and closing of this hydrant. This is normal operation.

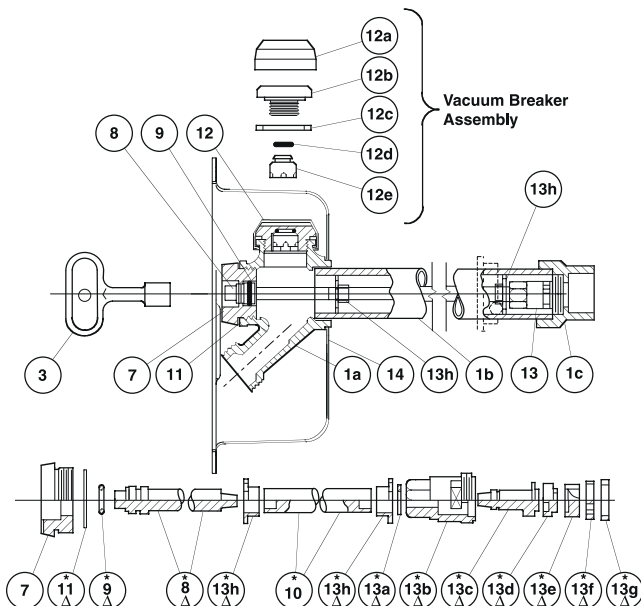

HYDRANT PARTS LIST					
NO.	DESCRIPTION	NO.	DESCRIPTION	NO.	DESCRIPTION
1	Head/Casing Assembly	10	Operator Rod	13a	Retaining Ring
1a	Head	11	Face Nut Washer	13b	Valve Body
1b	Casing	12	Vacuum Breaker Assembly	13c	Valve Actuator
1c	Valve Housing	12a	VB Cap	13d	Nylon Thrust Washer
3	Key	12b	VB Body	13e	Rotating Ceramic Disc
7	Face Nut	12c	VB Washer	13f	Fixed Ceramic Disc
8	Actuator Shaft	12d	VB "O" Ring	13g	Silicon Rubber Seal
9	Actuator "O" Ring	12e	VB Piston	13h	Retainer Guide (2)
		13	Valve Body Assembly	14	Box Assembly S.S.

△ These Replacement Parts Available in HPRK-7

* All Parts Accessible from Face of Hydrant by Removing Face Nut.