

FIGURE NUMBER	9667	DRAWN BY:	TBW	CHECKED BY:	PJ	APPROVED BY:	PJ	DATE:	3-30-15	SCALE:	NONE	SIZE	A	DRAWING NUMBER	s9667	N
---------------	-------------	-----------	-----	-------------	----	--------------	----	-------	---------	--------	------	------	---	----------------	-------	---

DIMENSIONS ARE SUBJECT TO MANUFACTURER'S TOLERANCE AND CHANGE WITHOUT NOTICE.

WE CAN ASSUME NO RESPONSIBILITY FOR USE OF SUPERSEDED OR VOID DATA.

Fine-Line® STAINLESS STEEL ADA LINEAR DRAIN

Fine™ Linear Drains

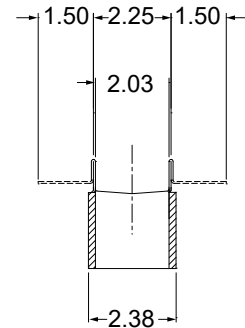
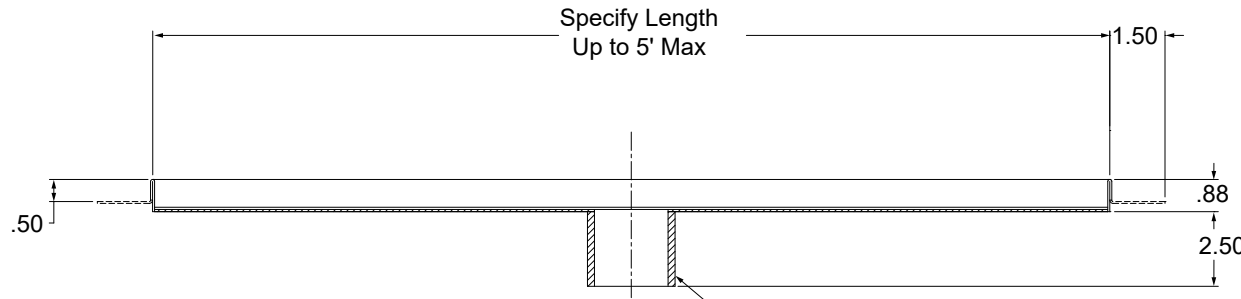
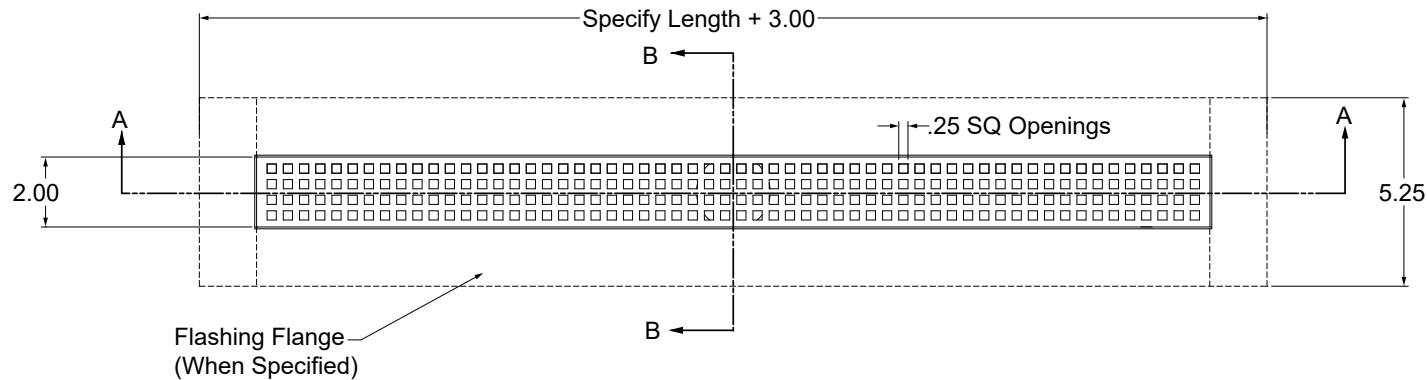

NOTE: Grate Locking Bars Should Be Located Away From Over The Outlet. Outlet Opening Must Be Clear Of Obstructions.

SECTION A-A — 2" NO-HUB Outlet

SECTION B-B

REGULARLY FURNISHED:

Fabricated 18 Ga Type 304 Stainless Steel Body with Satin Finish and Loose Set Stainless Steel Perforated Grate (-SPG) and 2" NO-HUB Bottom Outlet. Grate has .25 Square Perforations.

VARIATIONS:

- Slotted Grate -SLG
- Wave Grate -WG
- Solid Rim Flow Grate -SRFG
- Tile Inlay Grate -TIG
- Secured Grate -U
- Flashing Flange -F
- 2" NPT Female Threaded Outlet

OPTIONAL MATERIALS:

- 316 Stainless Steel -316

OPTIONAL FINISHES:

- High Polished Finish -HP

LENGTHS AVAILABLE:

- 12" 36" 60"
- 24" 48"

NOTE: See Back Sheet for Grates

SMITH® JAY R. SMITH MFG. CO.®
 MEMBER OF MORRIS GROUP INTERNATIONAL
 POST OFFICE BOX 3237
 MONTGOMERY, ALABAMA 36109-0237 (USA)
 TEL: 334-277-8520 FAX: 888-377-7818 www.jrsmith.com



N	11-18-22	Removed Function	HS	CL
M	3-9-23	Added NOTE	KK	PJ
L	1-19-23	Added UPC	KK	PJ
K	1-17-23	Updated Title	KK	PJ
REV.	DATE	DESCRIPTION	BY	CKD.

FIGURE NUMBER	9667-BS	DRAWN BY:	TBW	CHECKED BY:	PJ	APPROVED BY:	PJ	DATE:	3-31-15	SCALE:	NONE	SIZE	A	DRAWING NUMBER	s9667-BS	C
---------------	----------------	-----------	-----	-------------	----	--------------	----	-------	---------	--------	------	------	---	----------------	----------	---

DIMENSIONS ARE SUBJECT TO MANUFACTURER'S TOLERANCE AND CHANGE WITHOUT NOTICE.

WE CAN ASSUME NO RESPONSIBILITY FOR USE OF SUPERSEDED OR VOID DATA.

Fine-Line® OPTIONAL GRATES

Fine-Line
Linear Shower Drains

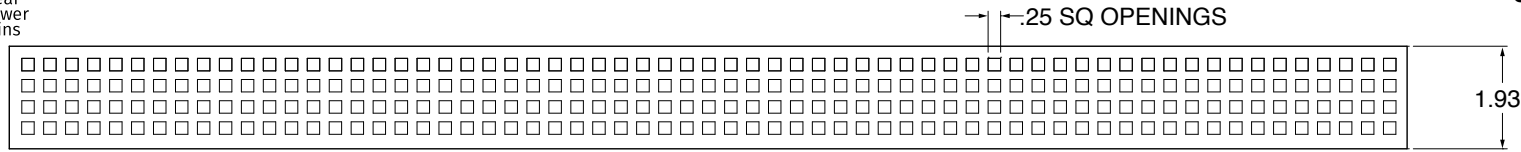

PERFORATED GRATE -SPG (STANDARD GRATE)

OPEN AREA OF GRATES IN SQUARE INCHES

12"	6.25
24"	12.50
36"	18.75
48"	25.00
60"	31.25

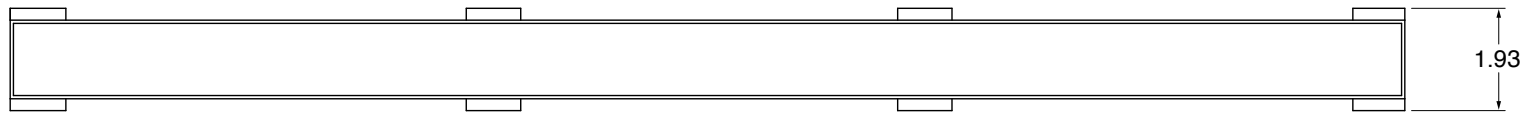

TILE INLAY GRATE -TIG, GRATE SEAT DEPTH IS .50"

12"	3.36
24"	6.72
36"	10.08
48"	13.44
60"	16.80

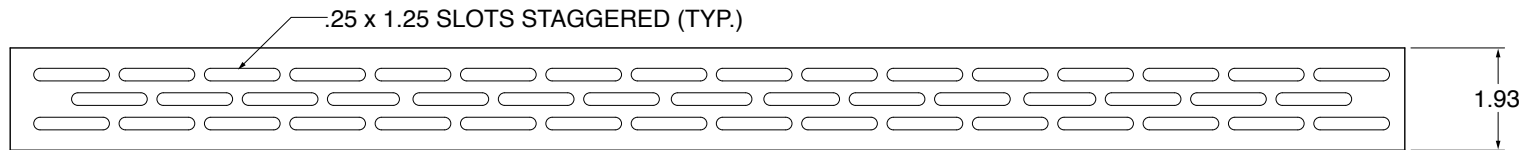

SLOTTED GRATE -SLG

12"	8.59
24"	17.18
36"	25.77
48"	34.36
60"	42.95

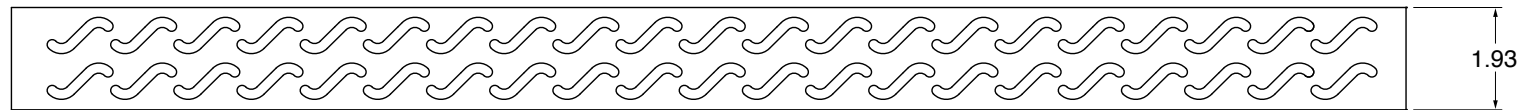

WAVE GRATE -WG

12"	5.84
24"	11.68
36"	17.52
48"	23.36
60"	29.20

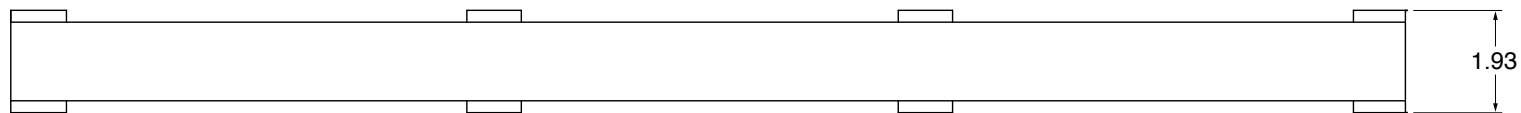

SOLID RIM FLOW GRATE -SRFG

12"	3.00
24"	6.00
36"	9.00
48"	12.00
60"	15.00

SMITH® JAY R. SMITH MFG. CO.®
 MEMBER OF MORRIS GROUP INTERNATIONAL
 POST OFFICE BOX 3237
 MONTGOMERY, ALABAMA 36109-0237 (USA)
 TEL: 334-277-8520 FAX: 888-377-7818 www.jrsmith.com



C	2-28-20	Revised Var. -SG to -SLG	MW	PJ
B	11-13-19	Added Tile Grate Seat Depth	MW	PJ
A	11-17-16	Added -SPG Grate and Tables	TBW	MD
REV.	DATE	DESCRIPTION	BY	CKD.

WARNING: Cancer and Reproductive Harm - www.P65Warnings.ca.gov