

CLEANOUTS

FIG. 4333, 4338 MULTI-PURPOSE FLOOR CLEANOUTS W/ INTERNAL CLOSURE PLUG AND ROUND NON-ADJUSTABLE CAST IRON TOP

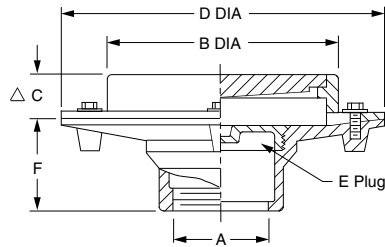

FUNCTION: Used in areas where a large access cover is desirable and the appearance of cast iron is satisfactory. Non-Tilt cover Fig. 4338 shown below should be used for heavy load traffic.



**Fig. 4333
Medium Duty Top**

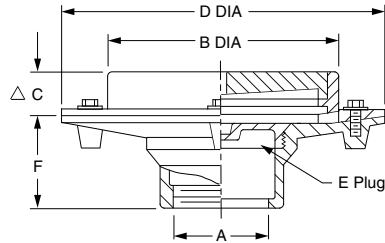

**Fig. 4338
Heavy Duty Top**

OUTLET VARIATIONS (Specify type of outlet and pipe size in inches.)

| Outlet Type | Outlet Designation | ADD |
|--------------|--------------------|---------------|
| Inside Caulk | C02, C03, C04 | N/C |
| Threaded | T02, T03, T04 | N/C |
| No-Hub | Y02, Y03, Y04 | See Fig 2646Y |

| OPTIONS: | ADD |
|------------------------------|--------|
| -G Galvanized CI | 446.00 |
| -M Ductile Iron Cover (4338) | 349.00 |
| -RT Recessed for Tile | 349.00 |
| -S Square Top, CI | 322.00 |
| -SEC Secured Cover | 146.00 |
| -SNB Square Top, add to CI | 804.00 |
| -SPB Square Top, add to CI | 684.00 |
| -TP "T" Handle for Plug | 77.00 |
| -U Vandal Proof Screws | 146.00 |

| A OUTLET SIZE | B TOP DIA | ΔC | D FLANGE DIA | E PLUG SIZE | F | †DUCO CAST IRON (-CI) | NICKEL BRONZE (-NB) | POLISHED BRONZE (-PB) | APPROX. WEIGHT LBS |
|---------------------|-----------------|--------|--------------------|-------------------|----|-----------------------------|---------------------------|-----------------------------|--------------------------|
| 02" | 8 1/2" | 1 5/8" | 12" | 3 1/2" | 4" | 990.00 | 1,398.00 | 1,335.00 | 33 |
| 03" | 8 1/2" | 1 5/8" | 12" | 4" | 4" | 990.00 | 1,398.00 | 1,335.00 | 33 |
| 04" | 8 1/2" | 1 5/8" | 12" | 5" | 4" | 1,115.00 | 1,523.00 | 1,460.00 | 33 |

REGULARLY FURNISHED: Duco Cast Iron Body with Scoriated Loose Set Cast Iron Cover, Taper Thread Bronze Closure Plug and Flashing Collar.

Δ Add 1/4" when bronze top is specified