

H



**JAY R. SMITH MFG. CO.**  
 MEMBER OF MORRIS GROUP INTERNATIONAL  
 POST OFFICE BOX 3237  
 MONTGOMERY, ALABAMA 36109-0237 (USA)  
 TEL: 334-277-8520 FAX: 334-272-7396 www.jrsmith.com



MEMBER OF:

LOCATION

DRAWING NUMBER  
S9935

SIZE  
A

SCALE:  
NONE

DATE:  
10/01/99

APPROVED BY:  
PACE

CHECKED BY:  
PACE

DRAWN BY:  
JJ

FIGURE NUMBER  
**9935**

WE CAN ASSUME NO RESPONSIBILITY FOR USE OF SUPERSEDED OR VOID DATA  
DIMENSIONS ARE SUBJECT TO MANUFACTURERS TOLERANCE AND CHANGE WITHOUT NOTICE

# 9935 SERIES ENVIRO-FLO® II INLINE CATCH BASIN

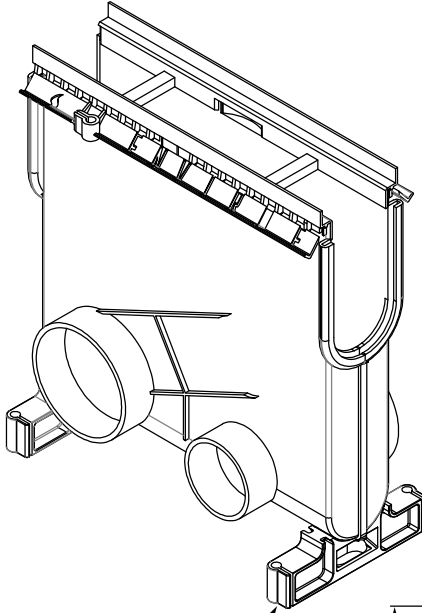

Rebar Installation Bracket  
(2 Per Basin)

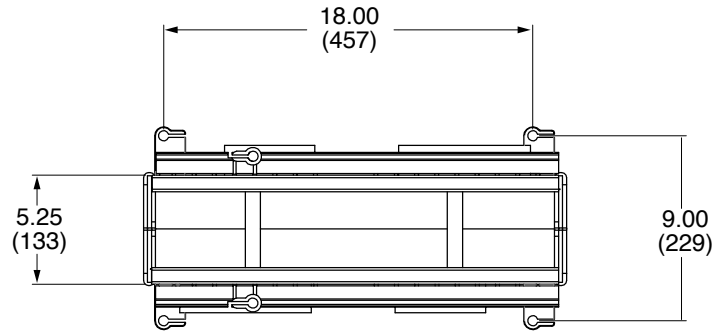

TOP VIEW

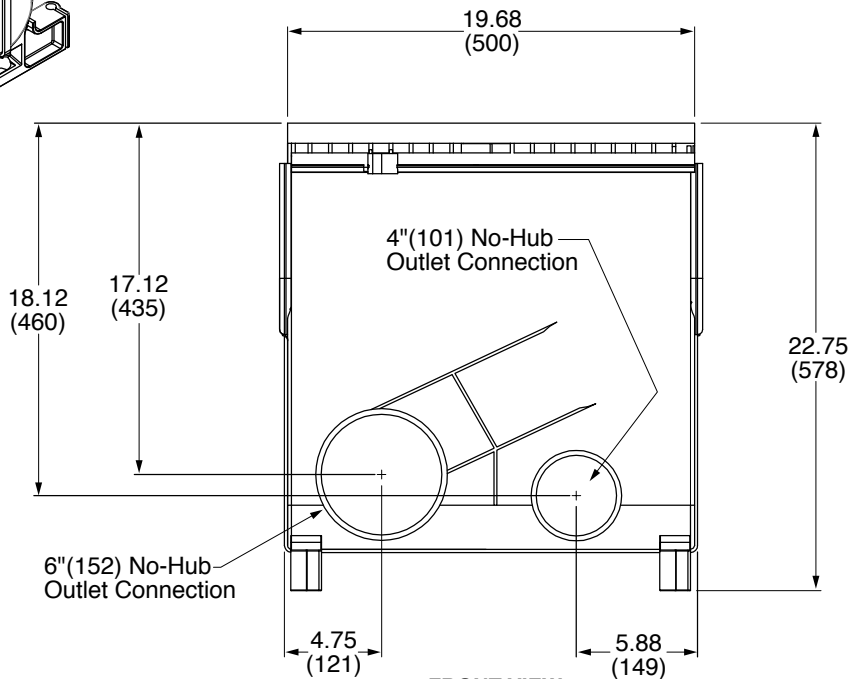

FRONT VIEW

4"(101) No-Hub Outlet Connection

6"(152) No-Hub Outlet Connection

**REGULARLY FURNISHED:**

100% Polypropylene with U.V. Inhibitors. Molded Catch Basin with 4" and 6" Preformed No-Hub Outlet Connection. Supplied with Secured Grate.

**NOTE:**

Catch basin requires a minimum of 4" of concrete or slab thickness, whichever is greater, around and under complete unit.

**NOTE:** Dimensions shown in Parentheses are in Millimeters

**VARIATIONS:**

- Plastic Sediment Bucket -BP
- Closing End Cap -ES
- Channel Shim 9930-ES\*
- Stainless Steel Overlay Rails



See back Sheet for Grate Specifications





\*NOTE: Shim is required if a channel shallower than a #20 is used with the basin. Cut shim to fit opening in the basin under the channel.

REV.	DATE	DESCRIPTION	BY	CKD. BY
H	4-19-13	Revised Drawing	TBW	MD
G	04/11/05	Added Shim Note	JJ	PJ
F	06/13/01	Edited Notes	JJ	MD
E	3-02-00	Polypropylene was Polyethelene	SA	PACE

WEIGHT POUNDS	VOLUME CUBIC FEET	FIGURE NUMBER <b>9935</b>
------------------	----------------------	------------------------------



WARNING: Cancer and Reproductive Harm - www.P65Warnings.ca.gov

<b>J</b>	 <p><b>SMITH® JAY R. SMITH MFG. CO.®</b>          MEMBER OF MORRIS GROUP INTERNATIONAL          POST OFFICE BOX 3237          MONTGOMERY, ALABAMA 36109-0237 (USA)          TEL: 334-277-8520 FAX: 334-272-7396 www.jrsmith.com</p>	 MEMBER OF:	  MEMBER OF:	LOCATION
----------	--	---	--	----------

# 9935 CATCH BASIN GRATE SPECIFICATION BY LOAD CLASS

DRAWING NUMBER: **s9935BS**

SCALE: **NONE**

DATE: **08/02/93**

APPROVED BY: **PACE**

CHECKED BY: **PACE**

DRAWN BY: **TWK**

WE CAN ASSUME NO RESPONSIBILITY FOR USE OF SUPERSEDED OR VOID DATA

DIMENSIONS ARE SUBJECT TO MANUFACTURERS TOLERANCE AND CHANGE WITHOUT NOTICE

- |   |   |
|---|---|
| <p>Light Duty, DIN 19580 <b>Class A</b> - 3,500 lbs - 70 psi<br/>For pedestrian, wheel chair and bicycle traffic</p> <ul style="list-style-type: none"> <li>* <input type="checkbox"/> 9870-410-GP- 1/4 dia. perforated galv. steel grate (28.30 SQ. IN. Open Area)</li> <li>* <input type="checkbox"/> 9870-420-G - 3 1/4 x 3/8 slotted galv. steel grate (35.20 SQ. IN. Open Area)</li> <li>* <input type="checkbox"/> 9870-451-SSPA- 1/4 dia. perforated stainless steel grate (28.30 SQ. IN. Open Area)</li> <li>* <input type="checkbox"/> 9870-445-SSADA- 13/16 x 3/16 longitudinal stainless steel slot bar grate (58.40 SQ. IN. Open Area)</li> <li>* <input type="checkbox"/> 9870-494-PADAB- 1 3/4 x 5/16 longitudinal slot black polypropylene grate (27.40 SQ. IN. Open Area)</li> <li>* <input type="checkbox"/> 9870-494-PADAG- 1 3/4 x 5/16 longitudinal slot gray polypropylene grate (27.40 SQ. IN. Open Area)</li> <li>* <input type="checkbox"/> 9870-491-HPP- 1 13/16" x .25 slotted black polypropylene grate non-Q-Lok (17.00 SQ. IN. Open Area)</li> </ul> | <p>Heavy Duty, DIN 19580 <b>Class C</b> -56,000 lbs - 1,162 psi<br/>For commercial pneumatic tire traffic patterns, forklifts and tractor trailers</p> <ul style="list-style-type: none"> <li>* <input type="checkbox"/> 9870-405-GM- 13/16 x 1/2 longitudinal galv. steel slot bar grate (121.10 SQ. IN. Open Area)</li> <li>* <input type="checkbox"/> 9870-411 -GPHD- 1/4 dia. perforated galv. steel grate (28.30 SQ. IN. Open Area)</li> <li>* <input type="checkbox"/> 9870-425-GHD- 3 1/4 x 3/8 slotted galv. steel grate (35.20 SQ. IN. Open Area)</li> <li>* <input type="checkbox"/> 9870-430-SSM- 1 3/16 x 1/2 longitudinal stainless steel slot bar grate (121.10 SQ. IN. Open Area)</li> <li>* <input type="checkbox"/> 9870-455-SSHD- 3 1/4 x 3/8 slotted stainless steel grate (42.60 SQ. IN. Open Area)</li> <li>* <input type="checkbox"/> 9870-479-MD- Mosaic pattern ductile iron grate (19.50 SQ. IN. Open Area)</li> <li>* <input type="checkbox"/> 9870-492-RC- 1 1/2 x 13/16 slotted resin composite grate (16.30 SQ. IN. Open Area)</li> <li>* <input type="checkbox"/> 9870-461-M - 3 15/16 x 3/8 ductile iron slotted grate (34.10 sq. in open area)</li> </ul> |
|---|---|

\* Supplied with QuickLok® securing device regularly furnished

**NOTE:** The grate securing bolts must remain secured in the grate and tightened to the locking bar installed in the channel. If the grate securing bolts are removed from the grates for maintenance of the trench drain, they must be replaced and retightened. If the grate securing bolts are left out of the grates, the life span of the trench drain system could be affected along with the safety of pedestrian traffic.

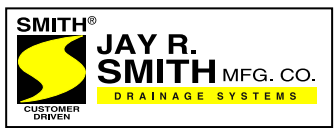

**9935BS**

FIGURE NUMBER	REV.	DATE	DESCRIPTION	BY	CKD.	WEIGHT POUNDS	VOLUME CUBIC FEET	FIGURE NUMBER								
			<table style="width:100%; border-collapse: collapse;"> <tr> <td style="width:15%; text-align: center;">9-9-14</td> <td style="width:85%;">Deleted 9870-440-VF/VF2</td> </tr> <tr> <td style="text-align: center;">9-16-13</td> <td>Revised Grates</td> </tr> <tr> <td style="text-align: center;">8-14-13</td> <td>Revised Grates</td> </tr> <tr> <td style="text-align: center;">4-19-13</td> <td>Revised Grates</td> </tr> </table>	9-9-14	Deleted 9870-440-VF/VF2	9-16-13	Revised Grates	8-14-13	Revised Grates	4-19-13	Revised Grates	TBW TBW TBW TBW	PJ MD MD MD			<b>9935BS</b>
9-9-14	Deleted 9870-440-VF/VF2															
9-16-13	Revised Grates															
8-14-13	Revised Grates															
4-19-13	Revised Grates															