

ROOF ACCESSORY

DOWNSPOUT NOZZLE

FUNCTION: Used as a parapet overflow or at the base of a wall where a concealed leader discharges rainwater to ground. Nozzle design diverts water away from building, eliminating wall stains. Wall flange covers rough opening and serves as anchor.

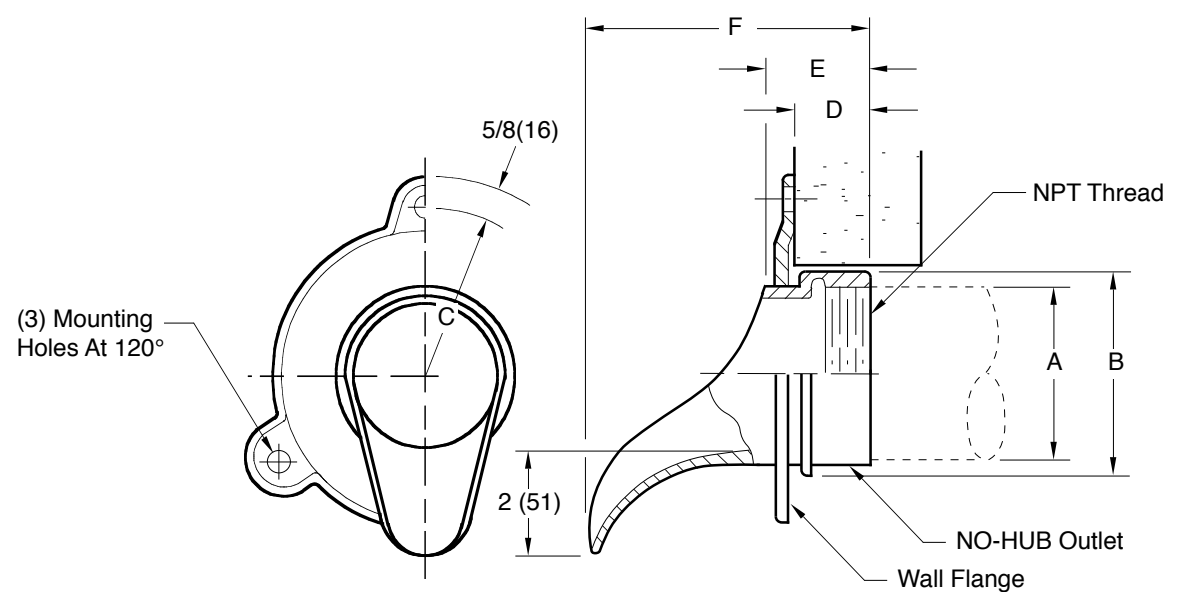

NOTE: For ADA Compliant See Fig. 1770-ADA

- Fig. 1770T.....Threaded Outlet
- Fig. 1770Y.....NO-HUB Outlet 02(50), 03(75), 04(100) and 06(150)

| | * | | | | * | | | | * | | * | |
|--------|----------------|----------------|----------------|----------------|----------------|-----------------|------------------|-----------------|-----------------|--|---|--|
| A=PIPE | 02(50) | 03(75) | 04(100) | 05(125) | 06T(150) | 06Y(150) | 08(200) | 10(255) | 12(305) | | | |
| B=DIA | 2 3/4 (70) | 4 (100) | 5 (125) | 6 (150) | 7 1/4 (185) | 7 1/4 (185) | 9 1/4 (235) | 11 1/8 (283) | 13 1/4 (335) | | | |
| C=RAD | 2 3/4 (70) | 3 1/2 (89) | 3 7/8 (98) | 4 3/8 (111) | 5 (125) | 5 (125) | 5 7/8 (149) | 7 1/4 (185) | 8 (205) | | | |
| D | 1 3/8 (35) | 1 3/8 (35) | 1 3/8 (35) | 1 3/8 (35) | 1 3/8 (35) | 1 13/16 (46) | 1 5/8 (41) | 1 3/4 (44) | 2 (51) | | | |
| E | 2 1/16 (52) | 2 1/16 (52) | 2 1/16 (52) | 2 1/16 (52) | 2 1/16 (52) | 2 1/2 (64) | 2 3/8 (60) | 2 3/4 (70) | 2 15/16 (75) | | | |
| F | 5 5/8 (143) | 5 5/8 (143) | 5 5/8 (143) | 5 5/8 (143) | 5 5/8 (143) | 6 1/4 (160) | 5 15/16 (149) | 5 3/8 (138) | 7 9/16 (192) | | | |

REGULARLY FURNISHED:
 Cast Bronze Nozzle and Flange.

VARIATIONS:

- Bird Screen -BS
- * NO-HUB Adaptor (specify Fig. 2646Y)
 [5"(125), 8"(200), 10"(255)
 and 12"(305) only]

OPTIONAL MATERIALS:

- Nickel Bronze -NB
- Polished Bronze -PB
- Chrome Plated -CP

NOTE: Dimensions shown in parentheses are in millimeters.

DRAWING NUMBER S1770
 SIZE A
 SCALE: NONE
 DATE: 2-25-85
 APPROVED BY: JD
 CHECKED BY: JD
 DRAWN BY: CR
 DIMENSIONS ARE SUBJECT TO MANUFACTURERS TOLERANCE AND CHANGE WITHOUT NOTICE

| | | | | | | | |
|------|----------|--------------------------|-----|---------|------------------|----------------------|------------------------------|
| J | 10-18-18 | Added Note ADA Compliant | TBW | CL | WEIGHT POUNDS | VOLUME CUBIC FEET | FIGURE NUMBER 1770 |
| H | 5-26-16 | Rev. Optional Materials | TBW | TK | | | |
| G | 01/14/11 | Added NO-HUB Outlet | JJ | TK | | | |
| F | 6-16-05 | Revised Table | RN | CL | | | |
| REV. | DATE | DESCRIPTION | BY | CKD. BY | | | |