

FIGURE NUMBER	9870-460-CI	DRAWN BY:	JJ	CHECKED BY:	MD	APPROVED BY:	PJ	DATE:	03/21/00	SCALE:	NONE	SIZE	A	DRAWING NUMBER	a9870-460-CI	A
---------------	--------------------	-----------	----	-------------	----	--------------	----	-------	----------	--------	------	------	----------	----------------	--------------	----------

DIMENSIONS ARE SUBJECT TO MANUFACTURERS TOLERANCE AND CHANGE WITHOUT NOTICE

WE CAN ASSUME NO RESPONSIBILITY FOR USE OF SUPERSEDED OR VOID DATA

9870-460-CI CAST IRON SLOTTED HEAVY DUTY GRATE

Heavy Duty, DIN 19580 Class C - 56,000 lbs - 1,162 psi
 For Commercial Pneumatic Tire Traffic Patterns, Forklifts and Tractor Trailers.

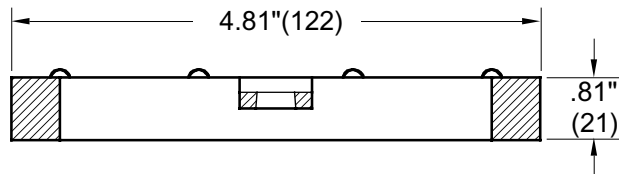
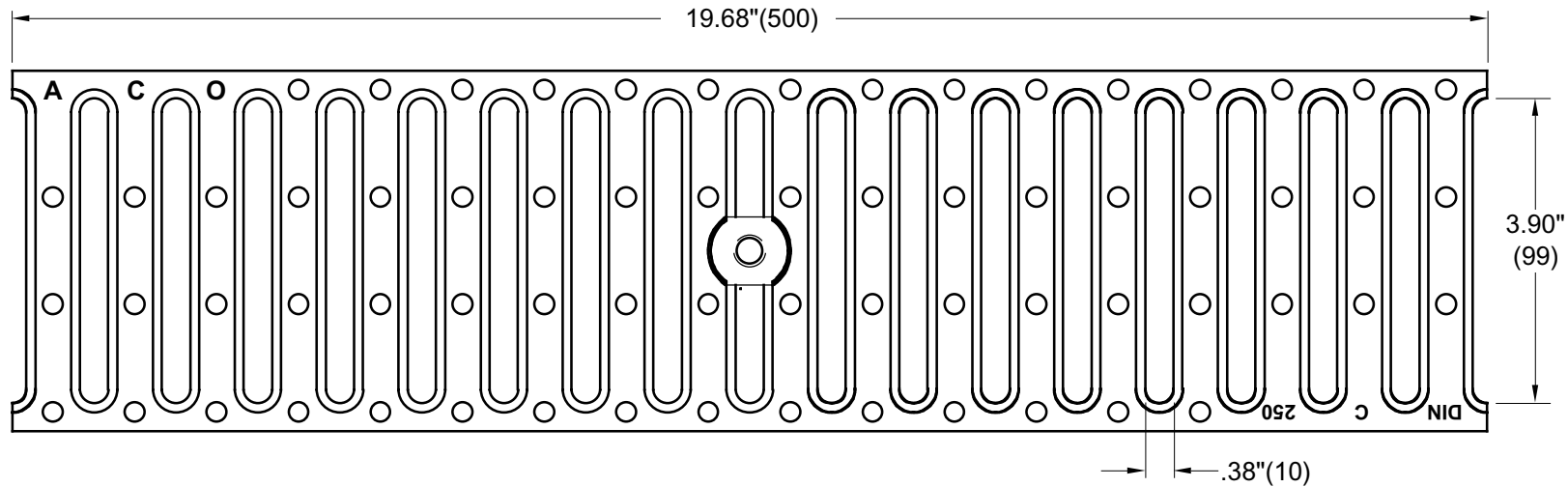

END VIEW SECTION

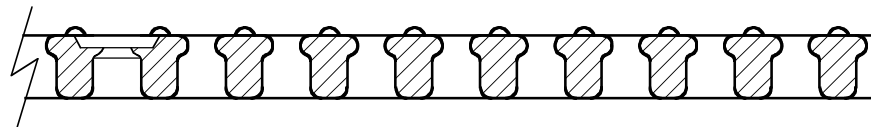

SIDE VIEW SECTION



REGULARLY FURNISHED:
 Black Duco coated 1/2 Meter
 Cast Iron Slotted Grate.

VARIATIONS:
 811LD Locking Device

OPEN AREA: 26.40 SQ. IN.

NOTE: Dimensions in parentheses are Metric.

SMITH® JAY R. SMITH MFG. CO.®
 DIVISION OF SMITH INDUSTRIES, INC.
 POST OFFICE BOX 3237
 MONTGOMERY, ALABAMA 36109-0237 (USA)
 TEL: 334-277-8520 FAX: 334-272-7396 www.jrsmith.com



A	09/14/04	Revised Load Rating Description	JJ	PJ
REV.	DATE	DESCRIPTION	BY	CKD. BY