

G



**JAY R. SMITH MFG. CO.**  
 DIVISION OF SMITH INDUSTRIES, INC.  
 POST OFFICE BOX 3237  
 MONTGOMERY, ALABAMA 36109-0237 (USA)  
 TEL: 334-277-8520 FAX: 334-272-7396 www.jrsmith.com



MEMBER OF:



LOCATION

# GUTTER DRAINS

**FUNCTION:** Rectangular top drains are adaptable to narrow scum gutters. Size of top selected is dependent on width of gutter and the amount of drainage area of top grate which is required. Angle types should be used where it is necessary to direct the connecting pipe through the gutter side wall.

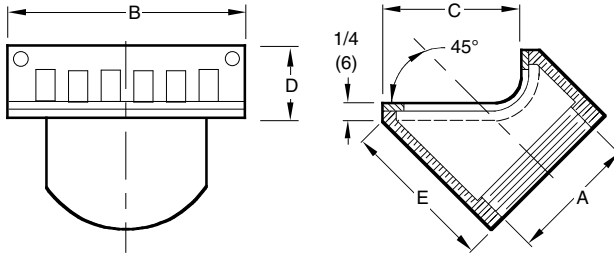

Fig. No.	B	C	D	E	Free Area
6250T	4(100)	2 3/4(70)	1 1/4(32)	3 1/4(83)	3.4 SQ IN (22) SQ CM
6270T	5 1/4(135)	2(51)	2(51)	3 1/4(83)	4.8 SQ IN (31) SQ CM

\*\*0250(65) Outlet available with Fig. 6270 only.

A (Pipe Size) = 0150(40), 02(50) or \*\*0250(65)

THREADED OUTLET ONLY

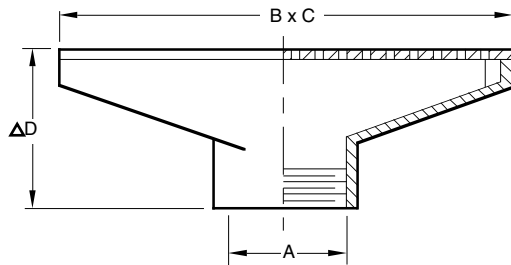

Fig. No.	"A" Size	B	C	D	Free Area
6205T	01(25), 0150(40), 02(50)	3 3/4(95)	2 1/4(57)	2 9/16(65)	2.7 SQ IN(17) SQ CM
6210T	02(50), 0250(65), 03(75)	5 9/16(141)	2 13/16(71)	2 15/16(75)	4.8 SQ IN(31) SQ CM
6215T	0150(40), 02(50)	9 1/8(232)	1 1/2(38)	2 5/8(67)	3.6 SQ IN(23) SQ CM
*6220T	0150(40), 02(50), 0250(65)	9(230)	3(76)	2 1/4(57)	11.4 SQ IN(74) SQ CM
*6225T	0150(40), 02(50), 0250(65)	10 1/8(257)	2 3/8(60)	3 3/16(81)	5.8 SQ IN(37) SQ CM
6230T	02(50), 0250(65), 03(75)	12 1/16(306)	4(100)	Δ 2 1/2(65)	11.3 SQ IN(73) SQ CM
6230T	04(100)	12 1/8(308)	4 1/8(105)	Δ 2 1/2(65)	11.3 SQ IN(73) SQ CM

ΔFor Figure No. 6230 only; when specifying NB, PB or CP add 3/8(10) to "D" dimension

\*Anchor flange variations available with figure nos. 6220 and 6225 only.

THREADED OUTLET ONLY

### REGULARLY FURNISHED:

Duco Cast Iron Body with Secured Chrome Plated Bronze Face.

### VARIATIONS:

\*Anchor Flange -F  
 NO-HUB Adaptor  
 (Specify Fig. 2646Y) 2(50), 3(75)  
 and 4"(100) Only  
 Vandal Proof Screws -U

### OPTIONAL MATERIALS:

Bronze Body -BB  
 Galvanized Cast Iron -G  
 Nickel Bronze Face -NB  
 Polished Bronze Face -PB  
 Stainless Steel  
 (Fig. 6230 only)  
 (Specify Fig. 9745)

**NOTE:** This product does not conform to or meet the requirements of ASME Standard No. A112.19.8-2007, titled "Suction Fittings for Use in Swimming Pools, Wading Pools, Spas, and Hot Tubs." This product shall not be used in any installation in swimming pools, wading pools, spas, hot tubs as well as other aquatic facilities. Due to the potential endangerment from arduous and forceful suction, entrapment or entanglement regardless of whether it is hair, head, limbs or other body parts, this product is prohibited from installation in these applications.

**NOTE:** Dimensions shown in parentheses are in millimeters.

DRAWING NUMBER  
S6200SIZE  
ASCALE:  
NONEDATE:  
4-5-83APPROVED BY:  
SJMCHECKED BY:  
DTDRAWN BY:  
BSFIGURE NUMBER  
6200

WE CAN ASSUME NO RESPONSIBILITY FOR USE OF SUPERSEDED OR VOID DATA

DIMENSIONS ARE SUBJECT TO MANUFACTURERS TOLERANCE AND CHANGE WITHOUT NOTICE

REV.	DATE	DESCRIPTION	BY	CKD. BY
G	12/17/08	Revised Table	RN	CL
F	12/08/08	Revised Variations	RN	CL
E	11/20/08	Added ASME Note	JJ	CL
D	06/12/03	Added Note	JJ	CL

WEIGHT  
POUNDSVOLUME  
CUBIC FEET

FIGURE NUMBER

6200