

RAINWATER HARVESTING INSTALLATION AND MAINTENANCE GUIDE RH9518-04

**Medium Capacity Vortex Rainwater Fine Filter
for
Above or Below Grade Application**

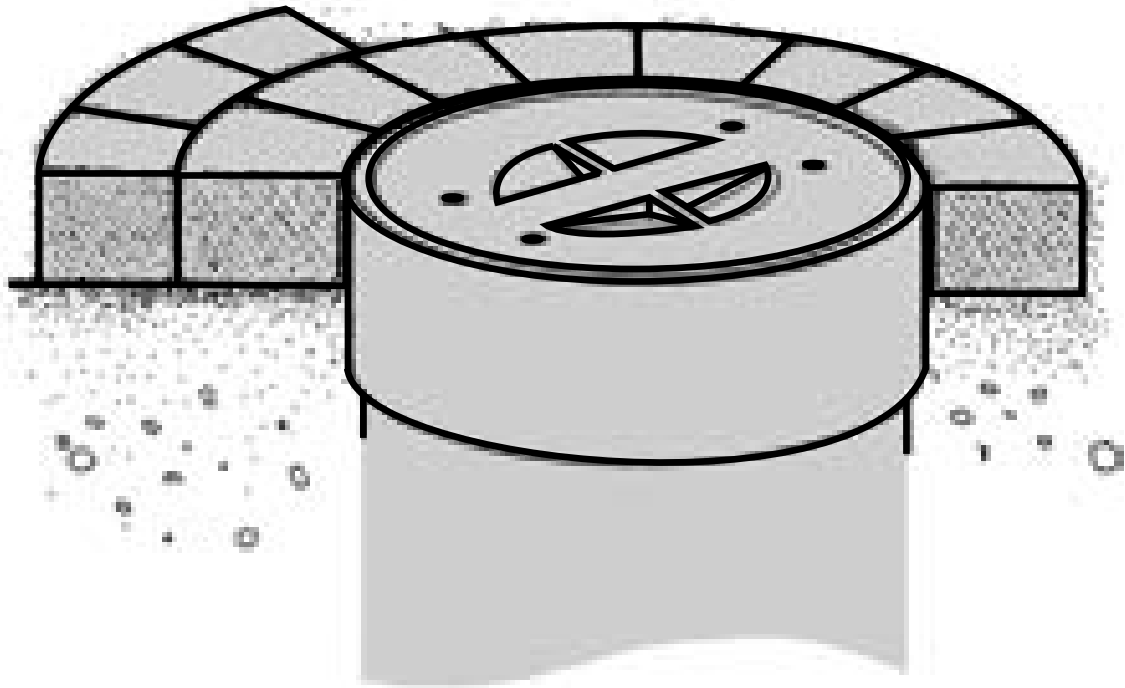

Please read these instructions carefully before installing the RH9518-04 Vortex filter.

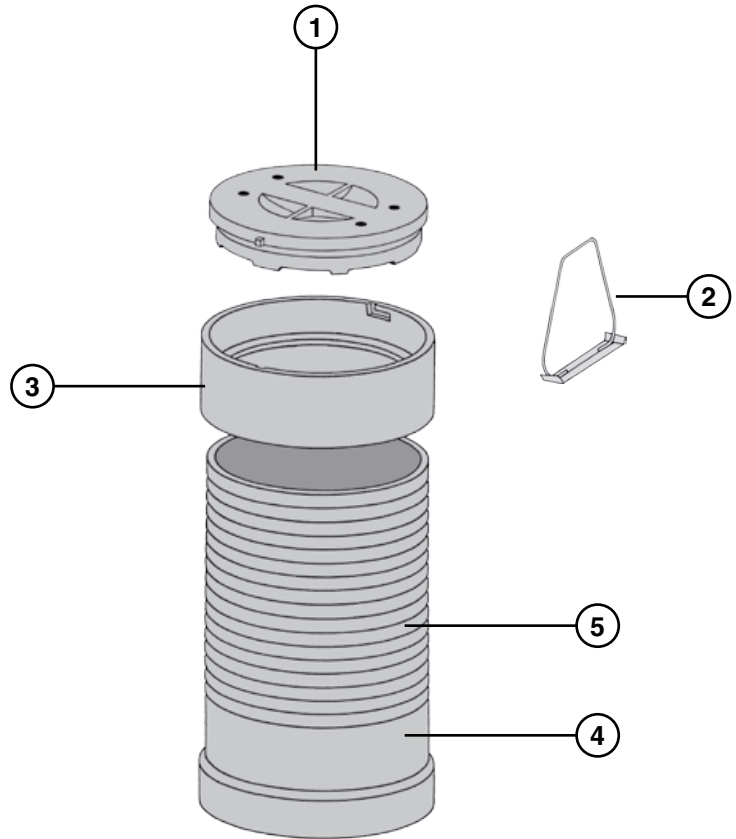

Components

- 1 Housing lid
- 2 Lifting handle
- 3 Top ring lid support
- 4 Extension tube
- 5 Saw slits
- 6 Filter insert
- 7 Rainwater inlet
- 8 Outlet to cistern
- 9 Outlet to drain

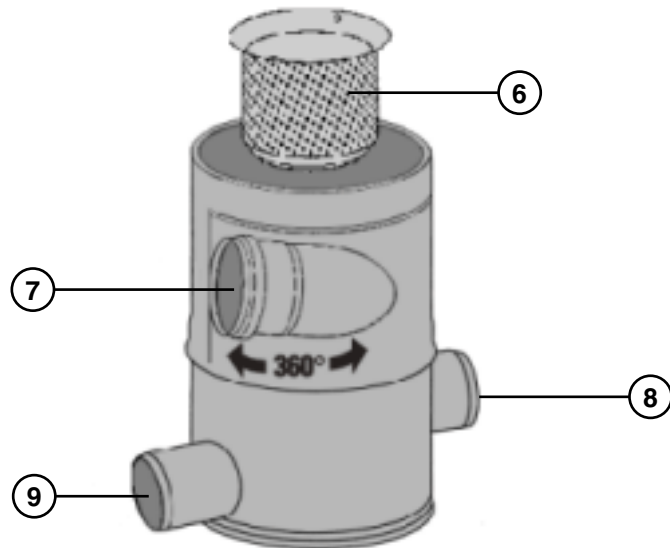

Installation Information

- Installation and connection sizes can be noted in the illustrations. Installation of an extension tube to raise the inspection opening should be considered prior to installation.
- Prior to installation in existing pipework, verify that a minimum height difference between the rainwater inlet pipe and the drain connection of 16" (40.6 cm) is possible.
- The difference in height between the rainwater inlet pipe and the pipe to the cistern must be 12" (30.5 cm).
- A "Settling length" of at least 20" (50 cm) is required in front of the rainwater inlet.

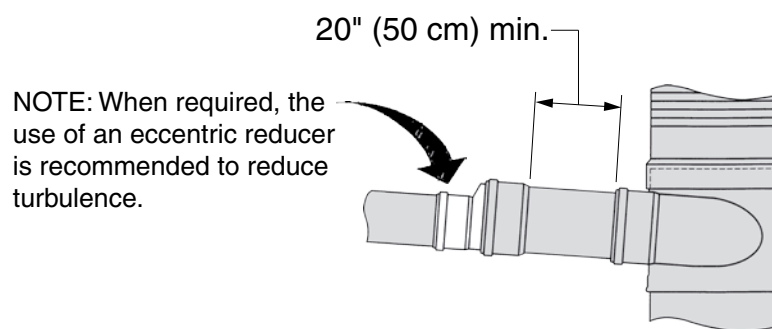

- The nominal size of the drain pipe may not be less than the nominal size of the rainwater inlet pipe, so that there is no restriction in the cross-section.
- To ensure that the filter can support loads up to its rating, an appropriately compacted subsoil or concrete slab is required.

The Installation

- Remove the transport packing cardboard from inside the housing.
- Carry out the excavation.
- Insert the filter and make the pipe connections. Rotate the rainwater inlet connection to the desired position. The filter must be installed exactly vertical (use a water level). If necessary, insert an extension tube up to ground level and screw it on.
- The inspection opening can be adjusted to ground level by cutting along the saw slits of the extension tube.

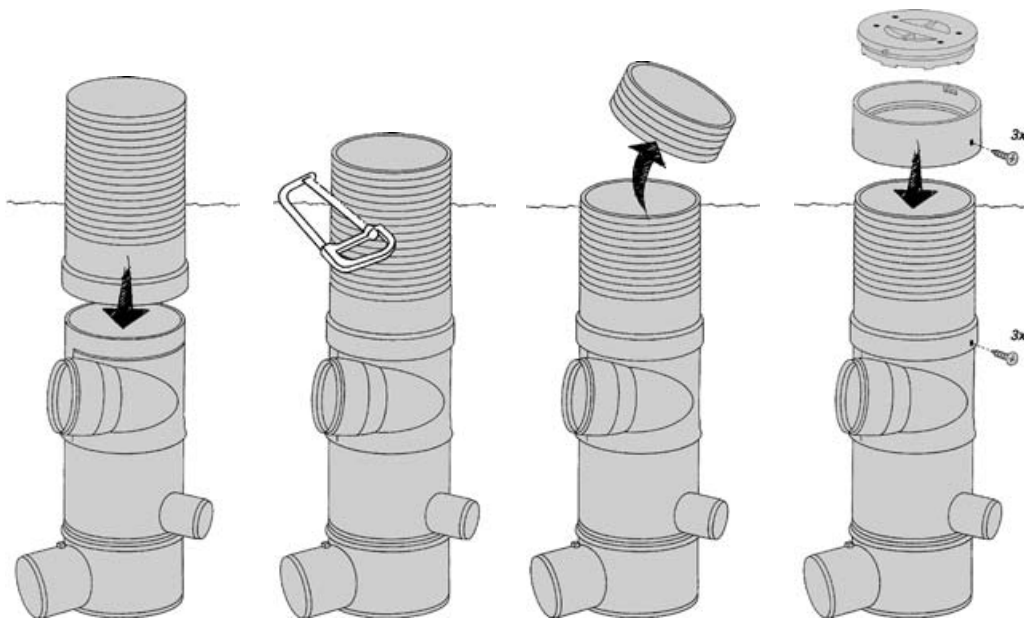

The extension tube is inserted directly into the filter housing and screwed through the holes with the enclosed stainless steel screws, before the filter is set in the ground.

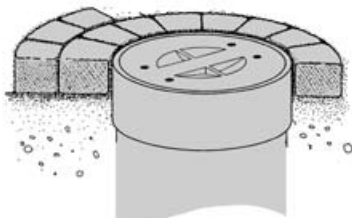

The Top Ring enables the paving to be fitted. The enclosed lid can be unlocked by turning to the left and then lifted out.

- The use of the top ring is required for reliable and safe securing of the housing lid. The top ring is placed either on the filter housing or on the extension tube. The top ring has to be screwed in place with three screws.
- For larger depths, up to two extension tubes can be assembled.

Cleaning the filter insert

- Remove the filter insert with the lifting handle provided.

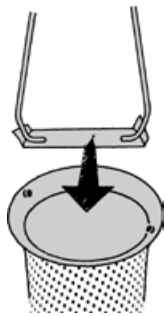

Set down the lifting handle...

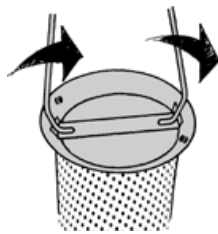

... turn clockwise under the lugs...



... and remove.

- We recommend cleaning every 180 days. Cleaning at shorter intervals may be necessary in unfavorable situations.

Experience has shown that cleaning in a dishwasher is adequate, provided the filter insert is placed in the same position in the dishwasher as it is in the filter. Cleaning by hand is also possible with a small brush, hot water and normal dishwashing liquid. For tenacious soiling of the filter mesh (e.g. through industrial pollution in the neighborhood), the use of a high pressure cleaner may be required.

Accessories

- **Extension tube** (RH9518ET)

An extension tube is available and is used to raise the lid by up to 22" (56 cm). Up to 3 extension can be used together.

- **Lifting handle** (RH9518LH25) (RH9518LH39)

The lifting handle included is usually long enough for most depths, but for greater depths there are lifting handles of appropriate lengths available.

- **Wall mounting** (RH9518WB)

A stainless steel wall bracket for internal roof drainage pipes in industrial buildings is available.

- **Seepage Basket** (RH9518SB)

This sieve (mesh size 1.6 mm) is added to the filter insert. It collects the large debris and as a result must be checked, emptied and cleaned more often. If this maintenance is not performed and a blockage results in water damages, we cannot accept any liability.

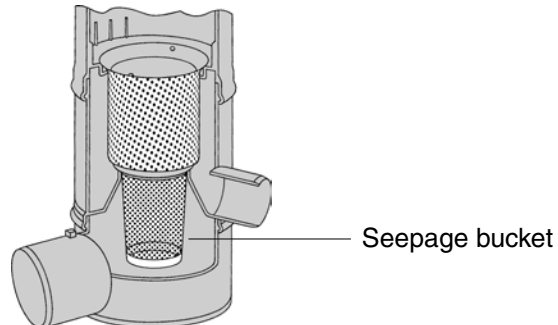

- **Blind insert** (RH9518BI)

The blind insert provides a direct throughflow of the rainwater into the drain. It is used instead of the filter insert. The blind insert is utilized when filling the cistern is not desired.

Damage in transit

Products are carefully checked before shipping, but the risk of damage during transport cannot be guaranteed.

- Check the goods for content and damage on receipt.
- Any damage is the responsibility of the carrier, register any claim with them immediately.
- Contact your supplier before returning any goods.



JAY R. SMITH MFG. CO.®
DIVISION OF SMITH INDUSTRIES, INC.
POST OFFICE BOX 3237
MONTGOMERY, ALABAMA 36109-0237 (USA)
TEL: 334-277-8520 FAX: 334-272-7396 www.jrsmith.com



MEMBER OF:

