

# ROOF DRAINS

## FIG. DX1250 SQUARE WIDE FLANGE BODY WITH NICKEL BRONZE TRACTOR GRATE

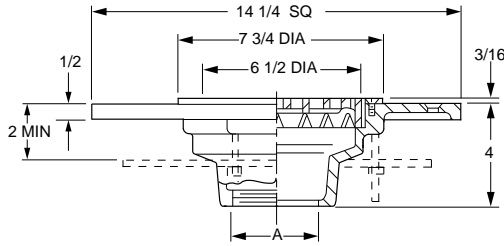

**FUNCTION:** Used in either wood or concrete deck installation where waterproof finished decks are installed. Large flange provides ample surface to receive the waterproofing membranes and the finished topping coat.



**OUTLET VARIATIONS** (Specify type of outlet and pipe size in inches.)

Outlet Type	Outlet Designation Type/Pipe Size	Body HT. DIM.	ADD
Inside Caulk	C02, C03, C04	4"	N/C
Threaded	T02, T03, T04	4"	47.00
No-Hub	Y02, Y03, Y04		See Fig. 2646Y

OPTIONS:	ADD
-B Sediment Bucket	75.00
-C Underdeck Clamp	90.00
-G Galvanized Cast Iron	271.00
-SH Securing Holes	74.00
-U Vandal Proof Grate	89.00

Use only where light rainfall is prevalent or in covered roof areas. When heavy rainfall is anticipated use DX1010 or DX2566.

A OUTLET SIZE	FLANGE SQ.	TOP SIZE	FREE AREA SQ IN	DUCO CI PB TOP	†DUCO CI NB TOP	APPROX. WEIGHT LBS
02, 03, 04"	14 1/4"	7 3/4"	12.5	794.00	857.00	38

**REGULARLY FURNISHED:** Duco Cast Iron Wide Flange Body with Nickel Bronze Tractor Grate and Rim.

## FIG. 1310 12" DIAMETER LOW PROFILE DOME

**FUNCTION:** Used in flat roofs of any construction where a medium sized drain is required. Flashing clamp holds flashing and roofing material without puncturing. Low profile dome protects sump and intercepts debris.

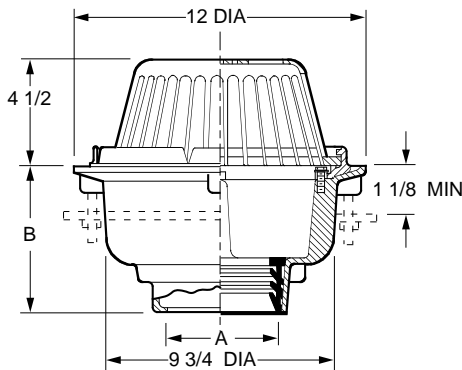

**OUTLET VARIATIONS** (Specify type of outlet and pipe size in inches.)

Outlet Type	Outlet Designation Type/Pipe Size	"B" Body HT. DIM.	ADD
Inside Caulk	C02, C03, C04, C05, C06	6"	N/C
Speedi-Set SW	L02, L03, L04	6"	N/C
Speedi-Set XH	LXH02, LXH03, LXH04	6"	N/C
Threaded	T02, T03, T04, T05, T06	4 3/4"	47.00
No-Hub	Y02, Y03, Y04, Y05, Y06	6"	N/C

OPTIONS:	ADD
-AD Aluminum Dome	109.00
-C Underdeck Clamp	90.00
-C2 Sec. Flash. Clamp	112.00
-CIDG Cast Iron Dome with Galvanizing	220.00
-CL Angular Underdeck Clamp	296.00
-E Ext. to 4" Per Inch, CI	52.00
-E04P 4" Perf SS Extension	383.00
-R Sump Receiver	156.00
-G Galvanized Cast Iron	238.00
-RBD Rough Bronze Dome	249.00
-RDP Roof Deck Plate	206.00
-SSM SS Mesh on Metal Dome	282.00
-U Vandal Proof Dome	69.00
-WD02 2" Solid Water Dam	117.00

A OUTLET SIZE	FLANGE DIA.	FREE AREA SQ IN	†DUCO CI POLY DOME	DUCO CI CI DOME	APPROX. WEIGHT LBS
02, 03, 04"	12"	71.5	383.00	383.00	27
05, 06"	12"	71.5	383.00	383.00	27

**REGULARLY FURNISHED:** Duco Cast Iron Body with Combined Flashing Clamp and Gravel Stop with Polyethylene Dome.