

P  
 DRAWING NUMBER S5509QT-SAP  
 SIZE A  
 SCALE: NONE  
 DATE: 12-20-90  
 APPROVED BY: CS  
 CHECKED BY: JCS  
 DRAWN BY: CMB  
**5509QT-SAP**  
 FIGURE NUMBER

WE CAN ASSUME NO RESPONSIBILITY FOR USE OF SUPERSEDED OR VOID DATA  
 DIMENSIONS ARE SUBJECT TO MANUFACTURERS TOLERANCE AND CHANGE WITHOUT NOTICE

# "QUARTERHORSE"- 1/4 TURN WALL HYDRANT WITH WARM CLIMATE HYDRANT

## INTEGRAL VACUUM BREAKER AND STAINLESS STEEL BOX BOX TYPE WITH CONCEALED HOSE CONNECTION

**FUNCTION:** Provides a concealed hose connection with integral vacuum breaker. For installation in exterior or interior walls where there is no danger of freezing. The stainless steel recessed box conceals the nozzle and operating mechanism. The locking cover prevents unauthorized use.

### 1/4 Turn of the Key Allows Full Flow to Be Obtained

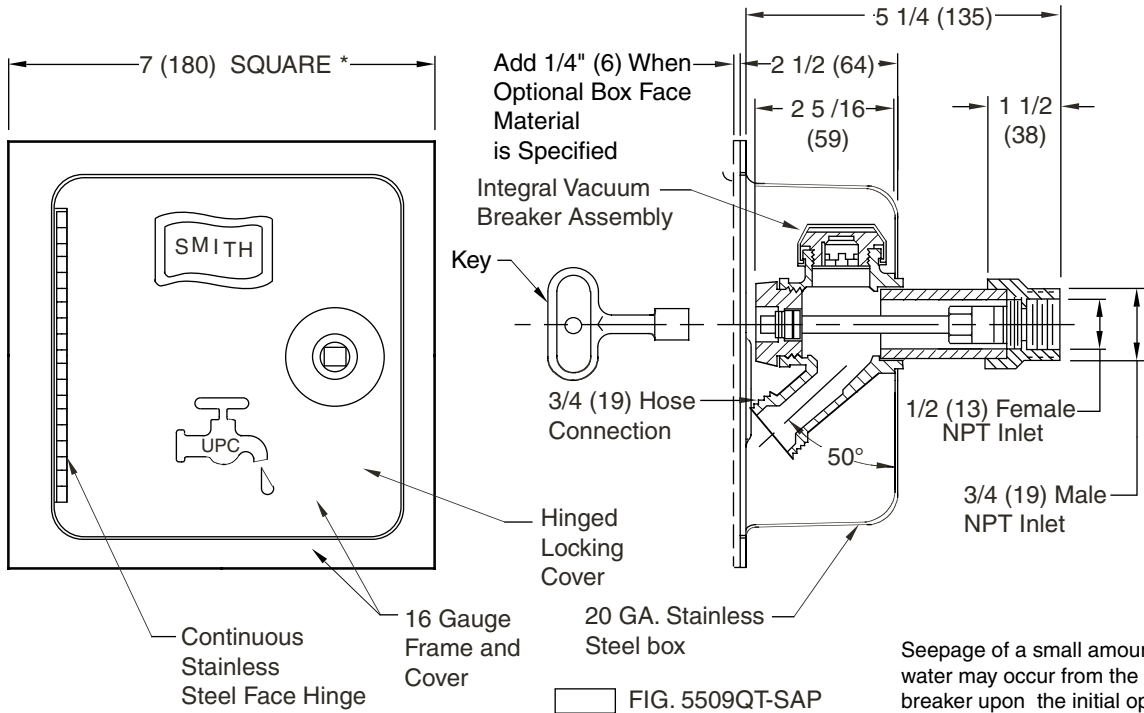

Seepage of a small amount of water may occur from the vacuum breaker upon the initial opening of this hydrant. This is normal operation.

**REGULARLY FURNISHED:**

Bronze Nickel Plated Quarter Turn Hydrant with Hose Connection, Integral Vacuum Breaker, "T" Handle Key, and Stainless Steel Box with Full 180° Cover Opening.

**VARIATIONS:**

- Cylinder -CL
- 1"(25) Hose Connection -HC1
- 1"(25) Male NPT Inlet Connection -IC1
- "Water" on Cover-W

**OPTIONAL MATERIALS:**

- Nickel Bronze Box Face -NB
- Polished Bronze Box Face -PB
- Rough Bronze Box Face -RB

\*\*Add 3/4" (19) to Overall Length When Specified

- NOTES:** \*
1. Recommended wall opening 6" (150) x 6" (150). Hydrant shall be in the vertical position only, the hose connection must be on the bottom.
  2. All Jay R. Smith hydrants are manufactured with "NO-LEAD" brazing rings, and USDA approved lubricants.
  3. When an Optional Box Face Material is Specified a Concealed Hinge Will be Provided, also add 1/4" (6) to Flange Thickness.
  5. The AB1953, California Lead Law, and NSF/ANSI Standard 61-2008 - Drinking Water System Components are not applicable to Jay R. Smith hydrants as they do not convey/dispense water for human consumption through drinking or cooking.
  6. Dimensions shown in parentheses are in millimeters.

**PATENTED**

P N M L	10-7-09 7-5-95 7-28-94 9-21-93	Revised Notes Added Millimeters Revised Submittal Update	RN EMB EMB EMB	CL BS BS BS	WEIGHT POUNDS	VOLUME CUBIC FEET	FIGURE NUMBER <b>5509QT-SAP</b>
REV.	DATE	DESCRIPTION	BY	CKD. BY			



# HYDRANT PARTS LIST

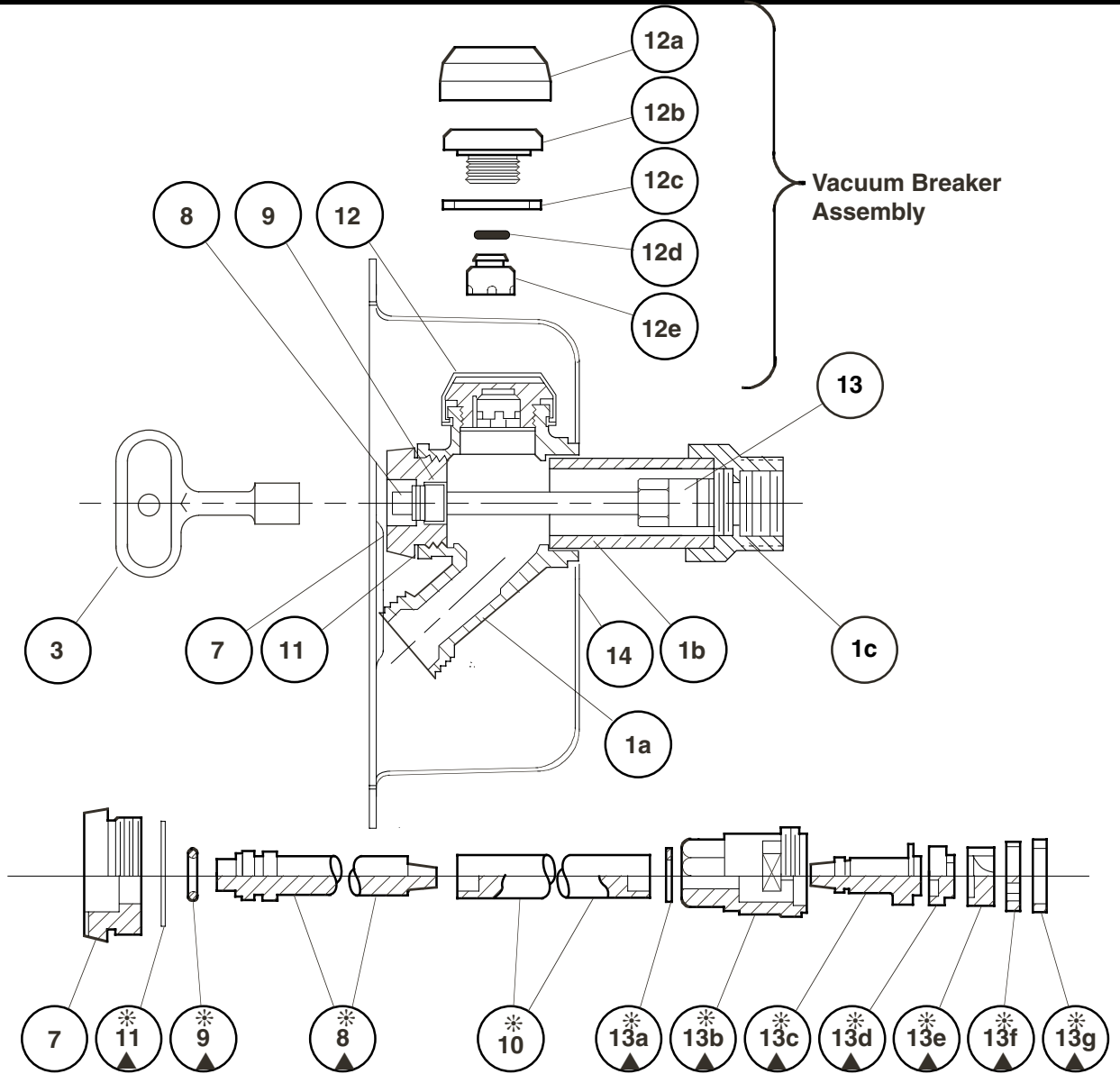

HYDRANT PARTS LIST					
NO.	DESCRIPTION	NO.	DESCRIPTION	NO.	DESCRIPTION
1	Head/Casing Assembly	10	Operator Rod	13a	Retaining Ring
1a	Head	11	Face Nut Washer	13b	Valve Body
1b	Casing	12	Vacuum Breaker Assembly	13c	Valve Actuator
1c	Valve Housing	12a	VB Cap	13d	Nylon Thrust Washer
3	Key	12b	VB Body	13e	Rotating Ceramic Disc
7	Face Nut	12c	VB Washer	13f	Fixed Ceramic Disc
8	Actuator Shaft	12d	VB "O" Ring	13g	Silicon Rubber Seal
9	Actuator "O" Ring	12e	VB Piston	14	Backer Plate w/Screws
		13	Valve Body Assembly		

▲ These Replacement Parts Available in HPRK-7

\* These Parts Accessible from Face of Hydrant by Removing Face Nut.

WE CAN ASSUME NO RESPONSIBILITY FOR USE OF SUPERSEDED OR VOID DATA

DIMENSIONS ARE SUBJECT TO MANUFACTURERS TOLERANCE AND CHANGE WITHOUT NOTICE

DRAWING NUMBER: S5509QTSAPBS  
 SIZE: A  
 SCALE: NONE  
 DATE: 12-28-90  
 APPROVED BY:  
 CHECKED BY:  
 DRAWN BY: EMB  
 FIGURE NUMBER: 5509QT-SAP-BS

C	11-12-91	Update Figure	TWK	BS
B	10-25-91	Update Figure Number	TWK	JCS
REV.	DATE	DESCRIPTION	BY	CKD. BY

WEIGHT POUNDS	VOLUME CUBIC FEET
---------------	-------------------

**FIGURE NUMBER**  
**5509QT-SAP**