

B



**JAY R. SMITH MFG. CO.®**  
 DIVISION OF SMITH INDUSTRIES, INC.  
 POST OFFICE BOX 3237  
 MONTGOMERY, ALABAMA 36109-0237 (USA)  
 TEL: 334-277-8520 FAX: 334-272-7396 www.jrsmith.com



MEMBER OF:



LOCATION

DRAWING NUMBER  
S2090

SIZE  
A

SCALE:  
NONE

DATE:  
4-10-70

APPROVED BY:

CHECKED BY:  
BH

DRAWN BY:  
JLS

WE CAN ASSUME NO RESPONSIBILITY FOR USE OF SUPERSEDED OR VOID DATA

DIMENSIONS ARE SUBJECT TO MANUFACTURERS TOLERANCE AND CHANGE WITHOUT NOTICE

# SPECIAL PURPOSE DRAINS

## PIT OR DEPRESSED AREA DRAIN

**FUNCTION:** Used in the side wall of pits such as the base of elevator shafts where a vertical grate and side outlet shallow rough-in is required. Optional backwater valve insures positive protection against backflow which could flood pit and damage equipment.

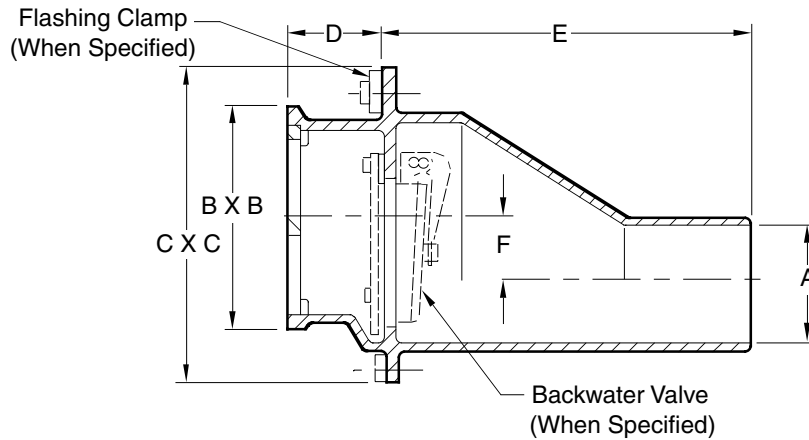

A (Pipe Size) = 03, 04, 05, 06, or 08

A SIZE	B X B	C X C	D	E	F	FREE AREA SQ IN
03, 04	6 3/4 X 9	10 1/4 X 12	3	11 1/4	2 1/2	17
05, 06	1/2	12 1/2 X 13	4	14	2 3/4	38
08	9 X 11 1/4	3/4	4	21 3/4	1 1/2	52

**REGULARLY FURNISHED:**  
 Duco Cast Iron Body and Secured Grate.

**VARIATIONS:**  
 Flashing Clamp -C  
 Backwater Valve -V

**OPTIONAL MATERIALS:**  
 Galvanized -G  
 Polished Bronze Face -PB  
 Nickel Bronze Face -NB

**NOTE:** These valves offer protection against backwater surges. Backflow is prevented when not obstructed by debris or sludge. Use for gravity flow only, not pressurized application.

# 2090

FIGURE NUMBER

REV.	DATE	DESCRIPTION	BY	CKD. BY
B	2-11-93	Chg'd BWV	EMB	JCS
A	12-31-80	Add Flashing Clamp	CR	

WEIGHT POUNDS

VOLUME CUBIC FEET

FIGURE NUMBER

# 2090