

**INSTALLATION INSTRUCTIONS FOR ADJUSTABLE AND COMPACT WATER CLOSET SUPPORTS SERIES 0100, 0200, 0400**

1. INSTALL FITTING TO SOIL LINE AT DESIRED PITCH AND CORRECT LOCATION. PLACE NEOPRENE FACE PLATE GASKET AGAINST THE FITTING FLANGE POSITIONING THE FOUR (4) BOLT HOLE OPENINGS OVER THE FOUR (4) BOLT HOLE TAPPINGS ON FITTING FLANGE.

2. REMOVE GREASE FROM TAPPED HOLES IN FITTING THEN ATTACH FACE PLATE TO FITTING WITH FOUR 1/2"(13) X 1 3/4"(44) BOLTS. ADJUST FACE PLATE TO REQUIRED ELEVATION DETERMINED BY CLOSET ROUGHING AND FINISHED FLOOR FILL. SECURING BOLTS SHOULD BE DRAWN UP UNIFORMLY SO THAT SEAL IS WATER AND GAS TIGHT.

2A. SPECIAL NOTE -- FOR VERTICAL COMPACT SUPPORTS (0400 SERIES) -- THIS SERIES IS NON-ADJUSTABLE. ROUGH FITTING IN STACK AT PROPER HEIGHT (DETERMINED BY CLOSET BOWL ROUGHING AND FINISHED FLOOR FILL.) FACE PLATE IS BOLTED TO FITTING WITH THREE 1/2"(13) X 1 1/4"(32) BOLTS. STEPS 1 AND 2 DO NOT APPLY TO THIS SERIES. FOLLOW STEPS 3 TO 10 FOR SETTING NIPPLE, ADJUST-TO-WALL COUPLING, BASE SUPPORTS AND MOUNTING OF CLOSET BOWL.

3. APPLY #90 SMITH SEAL AROUND THE ENTIRE CIRCUMFERENCE OF THE NPT END OF THE NIPPLE. SPREAD THE SMITH SEAL OVER THREE OR FOUR ROWS OF THREADS WITH A WOODEN TONGUE DEPRESSOR. THREAD THE NPT NIPPLE HAND TIGHT INTO THE FACEPLATE. USE A CHAIN WRENCH OR SIMILAR DEVICE TO ENSURE WATER TIGHTNESS. EXERCISE CAUTION NOT TO DAMAGE ANY THREADS. THREAD THE COUPLING ONTO THE NIPPLE AND SET 5/16" (8) BEYOND THE ANTICIPATED FINISHED WALL LINE. PLACE THE COUPLING PROTECTOR OVER THE COUPLING/NIPPLE DURING WALL CONSTRUCTION. \*\*SEE NOTE BELOW.

4. ATTACH 5/8"(16) STUDS TO FACE PLATE. ADJUST TO PROTRUDE 2 1/4"(57) BEYOND ANTICIPATED FINISHED WALL AND LOCK IN PLACE WITH HEX NUTS.

5. FASTEN BASE SUPPORTS TO FACE PLATE WITH 5/8"(16) X 1 1/4"(32) BOLTS. ANCHOR BASE TO FLOOR (WITH 1/2"(13) BOLTS PROVIDED BY INSTALLER). CHECK CENTERS OF STUDS AND COUPLING. ADJUST AND BEND IF NECESSARY. ALLOW SPACE (SLEEVE) IN WALL AROUND BOLT FOR FINAL ADJUSTMENT. AT THIS TIME, INSTALL -M51 ANCHOR FOOT ASSEMBLY PER INSTALLATION INSTRUCTIONS SHEET (S-M51). FOLLOW THE SAME PROCEDURE WHEN INSTALLING THE M54 AND M77 BASE SUPPORTS AND FACE PLATE.

6. AFTER WALL IS BUILT AND WATER CLOSET IS READY FOR SETTING, REMOVE PLASTIC SLEEVES FROM STUDS AND PLACE STEEL BEARING NUTS AND WASHERS ONTO STUDS. ADJUST NUTS SO THAT FACE OF STEEL WASHERS WILL SET 1/16"(2) BEYOND FINISHED WALL. CHECK CENTER OF STUDS AND COUPLING AGAIN AND ADJUST AS REQUIRED. USE SMITH -M17 SETTING GAUGE.

7. AFTER WALL CONSTRUCTION, REMOVE COUPLING AND APPLY #90 SMITH SEAL ON THE INTERNAL FEMALE THREADS AROUND THE ENTIRE DIAMETER. SPREAD OVER THREE OR FOUR ROWS OF THREADS WITH A WOODEN TONGUE DEPRESSOR. INSTALL THE COUPLING ON NIPPLE AND ADJUST TO THE APPROPRIATE DIMENSION BEYOND THE FACE OF THE FINISHED WALL, BUT NO LESS THAN 1/4" (6). (NOTE: DEPTHS OF HORNS AND FLANGE THICKNESSES VARY FROM DIFFERENT MANUFACTURERS. THE 1/4" (6) DIMENSION MUST BE ADJUSTED FOR DEEPER RECESSES.)

8. PLACE THE CLOSET GASKET AROUND THE HORN OF THE CLOSET BOWL.

9. MOUNT THE CLOSET ON SUPPORT STUDS. INSTALL THE FIBER WASHER, INSTALL THE TWO BOTTOM CAP NUTS AND THE TOP LEFT CAP NUT. TIGHTEN SECURELY WITH WRENCH. INSTALL FOURTH FIBER WASHER AND CAP NUT AND MAKE UP HAND TIGHT. THEN SNUG UP 1/4 TURN WITH WRENCH.

DIMENSIONS SHOWN IN PARENTHESES ARE IN MILLIMETERS.

\*\*THE CAST IRON COUPLING CAN BE USED TO TIGHTEN THE CAST IRON NIPPLE INTO THE FACE PLATE WHEN USED WITH THE SMITH CAST IRON COUPLING WRENCH. (NO CHARGE WHEN SPECIFIED)

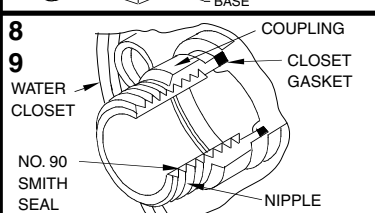
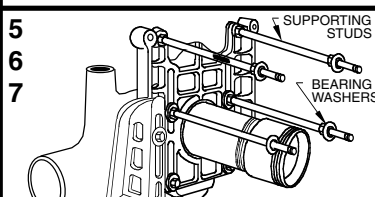
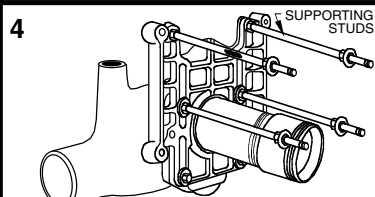
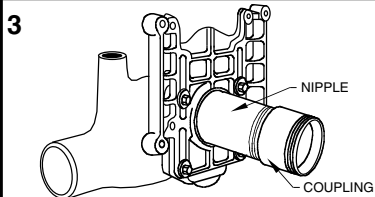
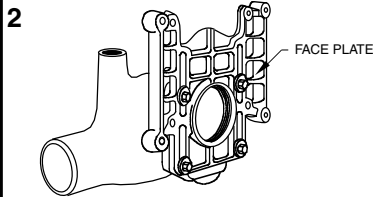
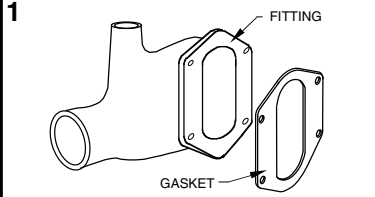
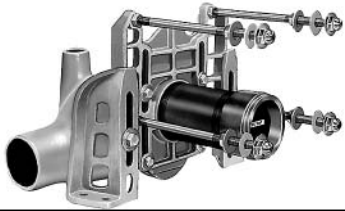

**INSTALLATION DRAWING OF NEOPRENE FACE PLATE GASKET FOR ADJUSTABLE CLOSET SUPPORTS**

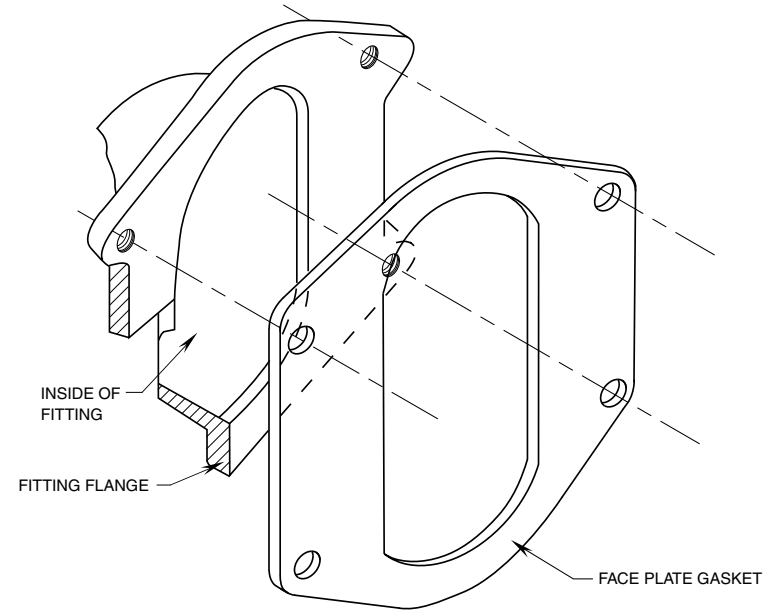

NOTE: This Gasket is not Applicable to the 0400 Series Closet Supports.

**INSTALLATION INSTRUCTIONS**

NOTE: Base support must be securely anchored to floor (with four 1/2"(13) bolts provided by contractor).

NOTE: Shallower minimum rough-in dimension to accommodate lower rough bowls available. Specify dimension required.

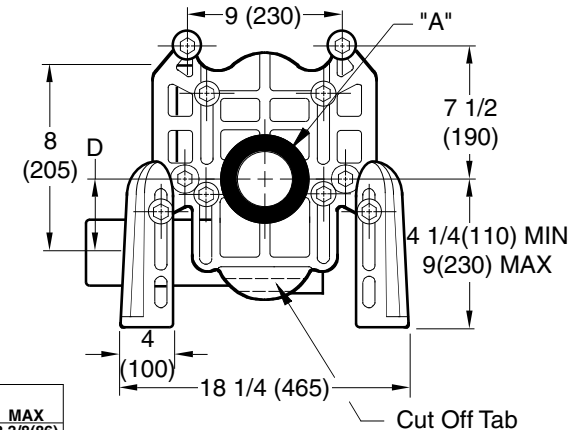

A SIZE	D MIN	D MAX
04(100)	5/8(16)	3/8(86)

**SIPHON JET INSTALLATION**

# MATERIAL SAFETY DATA SHEET

## RADIATOR SPECIALTY COMPANY

1400 W. INDEPENDENCE BLVD. • CHARLOTTE, NC 28208 • 704-377-6555

### SECTION I GENERAL INFORMATION

PRODUCT NAME	TITSEAL #2 GASKET AND JOINT COMPOUND
PART NUMBERS	T2-01, 03, 03V, 11
CHEMICAL DESCRIPTION	FORMULA
Mixture of castor oil, alcohol, resin and fillers	*Trade Secret

### SECTION II HAZARDOUS COMPONENTS

CAS NUMBER	COMPONENT	%	TLV
800-17-94	Castor oil	5-25	NA
67-63-0	Isopropyl alcohol	5-25	400 ppm

\*Components not identified are non-hazardous according to 29 CFR 1910.1200

### SECTION III PHYSICAL DATA

BOILING POINT	NA °F	SPECIFIC GRAVITY (H <sub>2</sub> O=1)	-1.5	pH	Neutral
FLASH POINT	160 °F	VOLATILE BY WT.	<15 %	EVAPORATION RATE	NA
SOLUBILITY IN WATER	slightly soluble	SOLUBILITY IN SOLVENTS	alcohols		
APPEARANCE AND ODOR	Black paste with characteristic odor				

### SECTION IV FIRE AND EXPLOSION DATA

EXTINGUISHING MEDIA
Water Fog ___ Foam <u>X</u> CO <sub>2</sub> <u>X</u> Dry Chemical <u>X</u> Other _____
SPECIAL FIRE FIGHTING PROCEDURES <i>Wear self-contained, positive pressure breathing apparatus and protective clothing.</i>
UNUSUAL FIRE AND EXPLOSION HAZARDS <i>None Known</i>

### SECTION V REACTIVITY INFORMATION (Based on data for individual components)

STABLE <u>X</u> UNSTABLE ___ HAZARDOUS POLYMERIZATION? YES ___ NO <u>X</u> CORROSIVE? ___ No
MATERIALS TO AVOID Oxidizing agents
CONDITIONS TO AVOID Temperatures above 120°F
HAZARDOUS DECOMPOSITION PRODUCTS At high temperatures - carbon monoxide, carbon dioxide, smoke

EMERGENCY TELEPHONE NUMBER  
704-377-6555

This information is presented to comply with the OSHA Hazard Communication Standard.

### SECTION VI HEALTH HAZARD INFORMATION (Based on data for individual components)

RECOMMENDED TLV OF PRODUCT	400 ppm
EYE	May cause eye irritation and corneal damage. Product is adhesive.
SKIN	Excessive exposure may cause skin irritation. Stains to the skin are difficult to remove.
INHALATION	Excessive inhalation of alcohol solvent may cause headache, narcosis, and irritate mucous membranes.
INGESTION	Harmful if swallowed. Product is adhesive and may cause choking.
OTHER	NA

### SECTION VII EMERGENCY AND FIRST AID PROCEDURES (Based on data for individual components)

EYE CONTACT	<i>Flush eye with water for 15 minutes.</i> Get medical attention immediately.
SKIN CONTACT	Wash with soap and water.
INHALATION	Move to fresh air. If patient is unconscious, give artificial respiration and get medical attention immediately.
INGESTION	Drink 2 glasses of water. INDUCE VOMITING. Get medical attention immediately.

### SECTION VIII SPECIAL PROTECTION INFORMATION (Based on data for individual components)

RESPIRATORY PROTECTION	EYE PROTECTION
For bulk handling, if TLV is exceeded, use NIOSH approved respirator	For bulk handling, wear goggles. Do not wear contact lenses.
VENTILATION	PROTECTIVE CLOTHING
General ventilation required.	For bulk handling, wear rubber gloves.

### SECTION IX SPILL OR LEAK PROCEDURES

SPILL OR LEAK PROCEDURES
Ventilate area. Remove ignition sources. Wipe up small spills with rags and burn waste carefully. Wash off stains with an alkaline detergent.
WASTE DISPOSAL METHODS <i>Dispose of in accordance of all applicable government laws and regulations.</i>

### SECTION X SPECIAL PRECAUTIONS

STORAGE AND HANDLING PRECAUTIONS	HAZARD INFORMATION LABEL DATA
Store at temperatures below 120°F away from ignition sources and oxidizing agents.	HAZARD CODE 4 = Extreme 3 = High 2 = Moderate 1 = Slight 0 = Negligible
OTHER PRECAUTIONS NA	FLAMMABILITY HEALTH REACTIVITY SPECIAL

While Radiator Specialty Company believes this data is accurate as of the revision date, we make no warranty with respect to the data and we expressly disclaim all liability for reliance thereon. The data is offered solely for your information, investigation and verification.

REVISED: \_\_\_\_\_ March, 1985 \_\_\_\_\_