

GUTTER DRAINS

FUNCTION: Used in gutters where a drain is required for connecting to the downspout leader. Flashing arrangement design permits removal of dome or flat strainer without disturbing flashing clamp and gutter liner.

FLAT STRAINER Does not obstruct traffic	LOW DOME Intercepts debris and allows adequate drainage in gutters and valleys	HIGH DOME Used where an abnormal amount of debris is anticipated
---	--	--

BOTTOM OUTLET

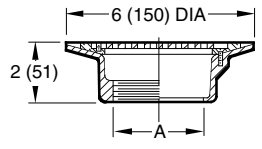

Fig. 1610T
Free Area: 7 SQ IN (45) SQ CM

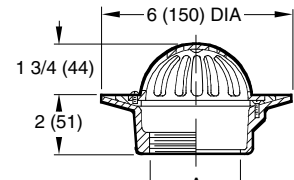

Fig. 1620T
Free Area: 8 SQ IN (52) SQ CM

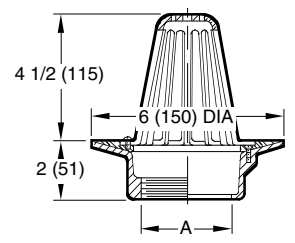

Fig. 1630T
Free Area: 24.5 SQ IN (158) SQ CM

A SIZE	02 (50)	02 (50)	03 (75)	04 (100)
OUTLET	Thread	Caulk	Thread	Thread
2"(51) Deep Body	✓	✓	✓	-
4"(100) Deep Body	✓	✓	✓	✓

REGULARLY FURNISHED:
2" (51) Deep Body
Threaded Outlet

45° OUTLET

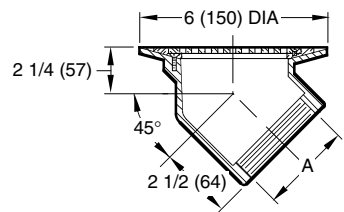

Fig. 1640T
Free Area: 7 SQ IN (45) SQ CM

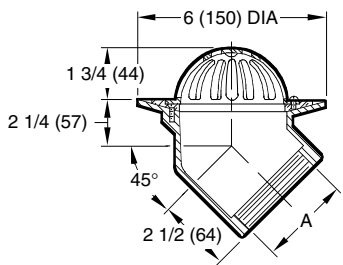

Fig. 1650T
Free Area: 8 SQ IN (52) SQ CM

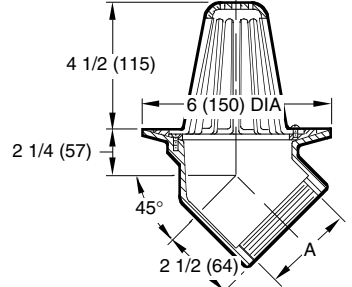

Fig. 1660T
Free Area: 24.5 SQ IN (158) SQ CM

Available In Threaded Outlet Only
A (Pipe Size) = 02(50), 03(75) or 04(100)

SIDE OUTLET

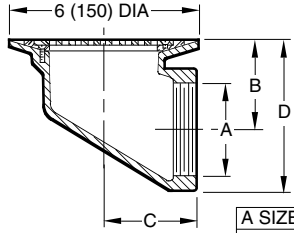

Fig. 1670T
Free Area: 7 SQ IN (45) SQ CM

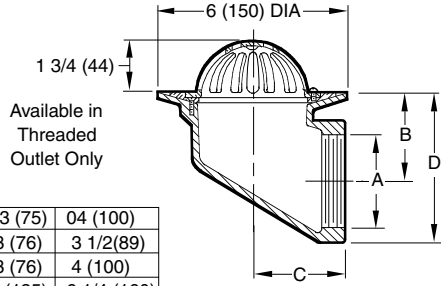

Fig. 1680T
Free Area: 8 SQ IN (52) SQ CM

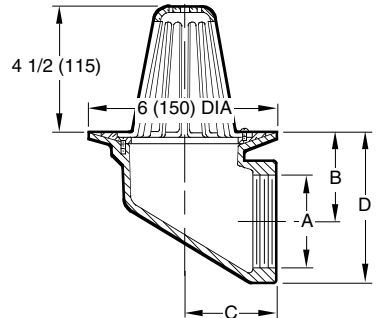

Fig. 1690T
Free Area: 24.5 SQ IN (158) SQ CM

REGULARLY FURNISHED:
Duct Cast Iron Body with Bronze Flashing Clamp and Bronze Top Secured with Brass Screws.

VARIATIONS:
 4" (100) Deep Body -B4 (Fig. 1610, 1620, 1630 only)
 Vandal Proof Screws -U

OPTIONAL MATERIALS:
 Galvanized Cast Iron Body -G
 Nickel Bronze Top -NB
 Polished Bronze Top -PB
 Bronze Body -BB

NOTE: Dimensions shown in parentheses are in millimeters.

DRAWING NUMBER: S1600-CAN
 SIZE: A
 SCALE: NONE
 DATE: 5-24-85
 APPROVED BY: TD
 CHECKED BY: TD
 DRAWN BY: CR
 1600 Series-CAN
 FIGURE NUMBER

WE CAN ASSUME NO RESPONSIBILITY FOR USE OF SUPERSEDED OR VOID DATA
 DIMENSIONS ARE SUBJECT TO MANUFACTURER TOLERANCE AND CHANGE WITHOUT NOTICE

REV.	DATE	DESCRIPTION	BY	CKD. BY	WEIGHT POUNDS	VOLUME CUBIC FEET	FIGURE NUMBER
F	7-14-05	Revised Function	RN	CL			1600 Series-CAN
E	6-16-99	Revised Millimeters	CMD	BS			
D	1-20-97	Rev Table & chg'd Opt Mat	EMB	BS			
C	6-13-95	Added Millimeters	EMB	BS			
B	6-30-94	Revised	EMB	BS			