

PARTS LIST WITH MAINTENANCE INSTRUCTIONS

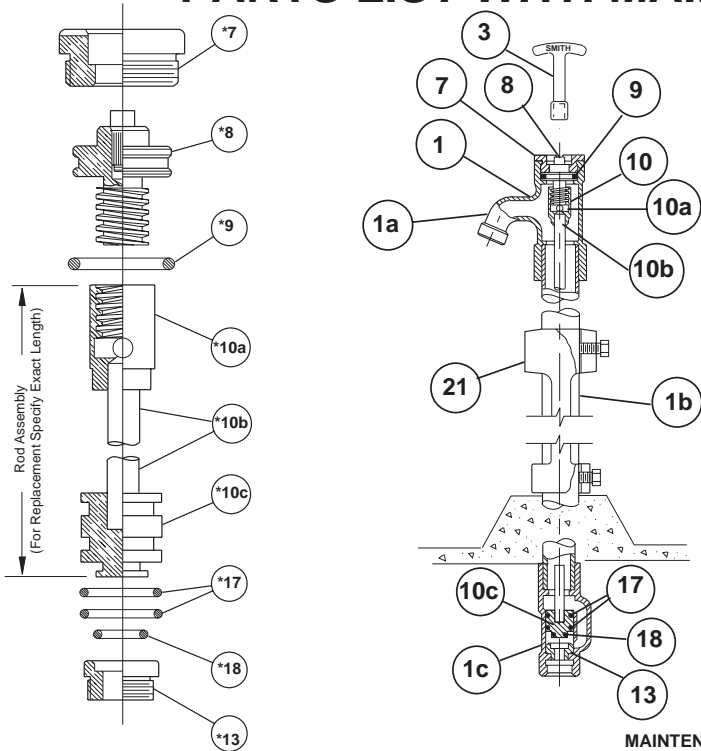

5910, 5911

REPLACEMENT PARTS LIST-SPECIFY FIGURE NO. WHEN ORDERING			
No.	DESCRIPTION	No.	DESCRIPTION
1	Head/Casing Assembly	10	Operating Rod Assembly
1a	Head	10a	Coupling
1b	Casing	10b	Rod
1c	Valve Housing	10c	Plunger
3	Key	13	Removable Seat
7	Face Nut	17	Plunger "O" Ring
8	Operating Screw	18	Plunger "O" Ring
9	Operating Screw "O" Ring	21	Casing Guard

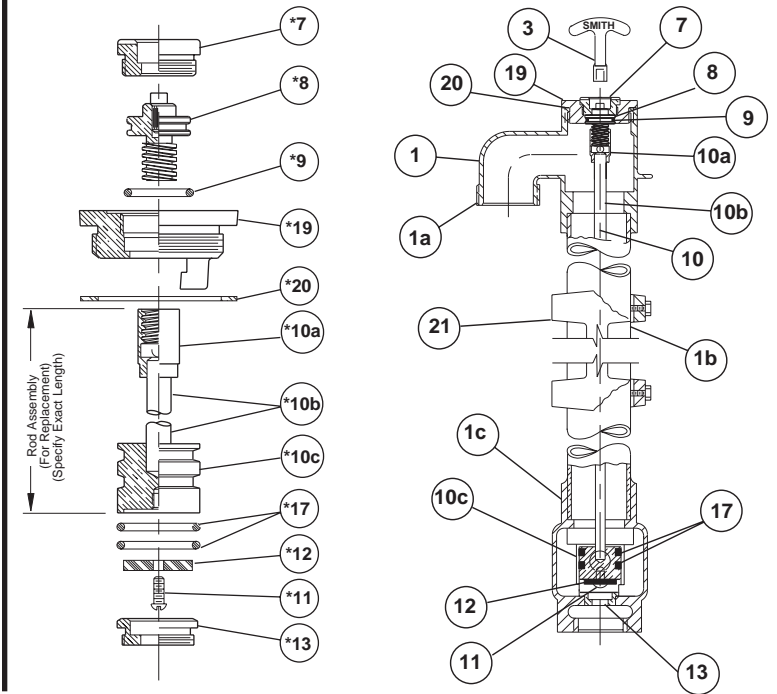

5912, 5913, 5914

REPLACEMENT PARTS LIST-SPECIFY FIGURE NO. WHEN ORDERING			
No.	DESCRIPTION	No.	DESCRIPTION
1	Head/Casing Assembly	10b	Rod
1a	Head	10c	Plunger
1b	Casing	11	Washer Screw (No. 10-24)
1c	Valve Housing	12	Washer (Neoprene)
3	Key	13	Removable Seat
7	Face Nut	17	Plunger "O" Ring
8	Operating Screw	19	Face Nut Seat
9	Operating Screw "O" Ring	20	Face Nut Seat Gasket
10	Operating Rod Assembly	21	Casing Guard
10a	Coupling		

MAINTENANCE INSTRUCTIONS

1. Shut off water supply.
2. Remove face nut.
3. Pull stem out for complete access to all working parts.
4. Check all working parts for replacement.
5. Replace complete stem assembly and face nut.

*These parts are accessible from face of hydrant by removing face nut.
NOTE: HYDRANT PART NUMBERS HAVE CHANGED OVER THE YEARS. CONSULT FACTORY BEFORE ORDERING REPLACEMENT PARTS.

PM 2809-A/Back

PARTS LIST WITH MAINTENANCE INSTRUCTIONS

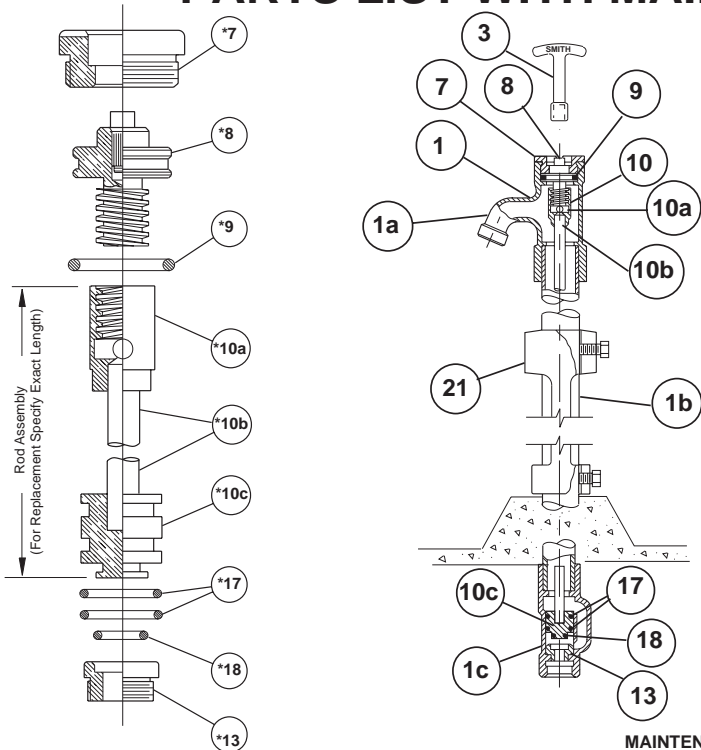

5910, 5911

REPLACEMENT PARTS LIST-SPECIFY FIGURE NO. WHEN ORDERING			
No.	DESCRIPTION	No.	DESCRIPTION
1	Head/Casing Assembly	10	Operating Rod Assembly
1a	Head	10a	Coupling
1b	Casing	10b	Rod
1c	Valve Housing	10c	Plunger
3	Key	13	Removable Seat
7	Face Nut	17	Plunger "O" Ring
8	Operating Screw	18	Plunger "O" Ring
9	Operating Screw "O" Ring	21	Casing Guard

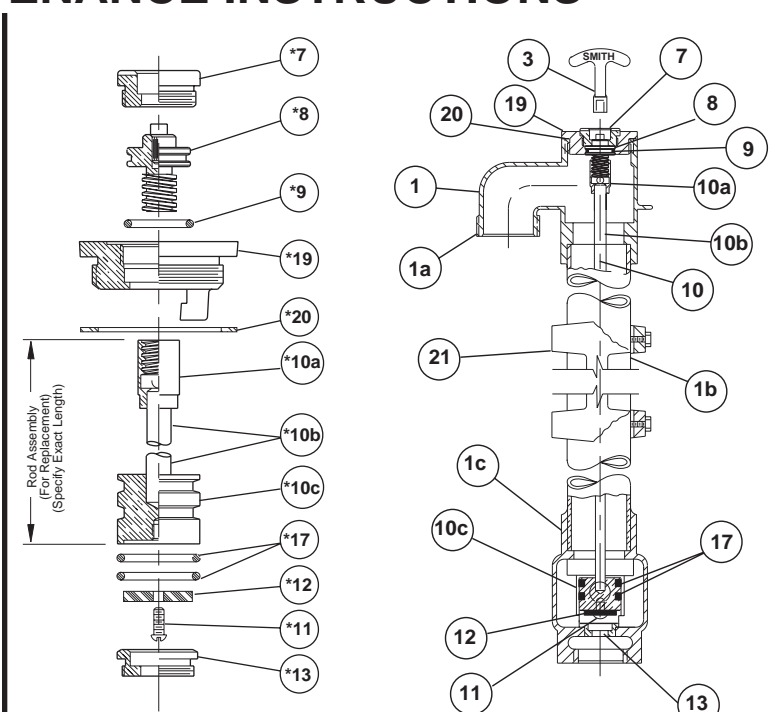

5912, 5913, 5914

REPLACEMENT PARTS LIST-SPECIFY FIGURE NO. WHEN ORDERING			
No.	DESCRIPTION	No.	DESCRIPTION
1	Head/Casing Assembly	10b	Rod
1a	Head	10c	Plunger
1b	Casing	11	Washer Screw (No. 10-24)
1c	Valve Housing	12	Washer (Neoprene)
3	Key	13	Removable Seat
7	Face Nut	17	Plunger "O" Ring
8	Operating Screw	19	Face Nut Seat
9	Operating Screw "O" Ring	20	Face Nut Seat Gasket
10	Operating Rod Assembly	21	Casing Guard
10a	Coupling		

MAINTENANCE INSTRUCTIONS

1. Shut off water supply.
2. Remove face nut.
3. Pull stem out for complete access to all working parts.
4. Check all working parts for replacement.
5. Replace complete stem assembly and face nut.

*These parts are accessible from face of hydrant by removing face nut.
NOTE: HYDRANT PART NUMBERS HAVE CHANGED OVER THE YEARS. CONSULT FACTORY BEFORE ORDERING REPLACEMENT PARTS.

PM 2809-A/Back