



**JAY R. SMITH MFG. CO.®**  
 DIVISION OF SMITH INDUSTRIES, INC.  
 POST OFFICE BOX 3237  
 MONTGOMERY, ALABAMA 36109-0237 (USA)  
 TEL: 334-277-8520 FAX: 334-272-7396 www.jrsmith.com



MEMBER OF:

LOCATION

# DX-FLOOR DRAIN WITH 12" (305) ROUND TOP

## HEAVY DUTY DRAIN WITH TRACTOR GRATE

**FUNCTION:** Used in heavy traffic areas where waste water contains no sediment or debris.

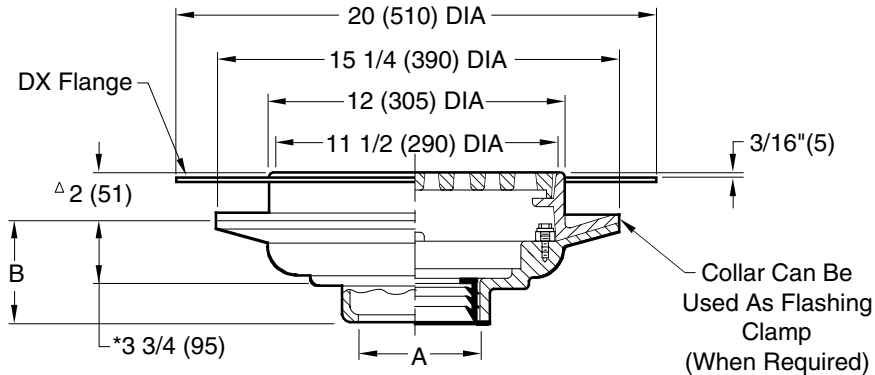

A (Pipe Size) = 02(50), 03(75), 04(100), 05(125) or 06(150)

Free Area  
29 SQ IN  
(187) SQ CM

Fig. DX-2140C . . . . CAULK OUTLET  
 Fig. DX-2140T . . . . THREAD OUTLET

Figure	B		
	Caulk	Thread	NO-HUB
2140	3 3/4 (95)	3 3/4 (95)	—

**REGULARLY FURNISHED:**

Duco Cast Iron Body and Flashing Collar with 4" Wide Fabricated DX Flange and Cast Iron Tractor Grate.

**VARIATIONS:**

- Flat Bottom Strainer -FBS
- Square Top -S
- Vandal Proof Grate -U

**OPTIONAL MATERIALS:**

- Ductile Iron Grate -M
- Galvanized Cast Iron -G
- Nickel Bronze Top -NB
- Polished Bronze Top -PB

\*This Dimension to Internal Stop of Speedi-Set Gasket.

Δadd 1/8" (3) when bronze top is specified.

**NOTE:** Dimensions shown in parentheses are in millimeters.

DRAWING NUMBER  
**SDX-2140**

SIZE  
**A**

SCALE:  
**NONE**

DATE:  
**4-17-07**

APPROVED BY:  
**TED**

CHECKED BY:  
**TED**

DRAWN BY:  
**RN**

**DX-2140**

FIGURE NUMBER

WE CAN ASSUME NO RESPONSIBILITY FOR USE OF SUPERSEDED OR VOID DATA

REV.	DATE	DESCRIPTION	BY	CKD. BY

WEIGHT  
POUNDS

VOLUME  
CUBIC FEET

FIGURE NUMBER  
**DX-2140**